

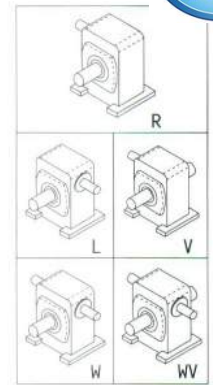

MODEL:TB

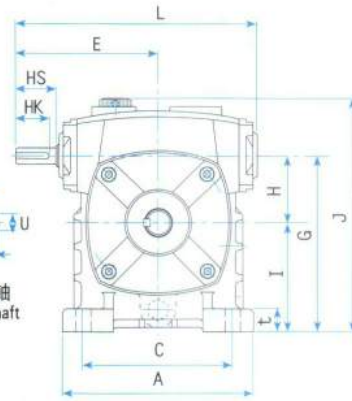

★ 40# ~ 175#

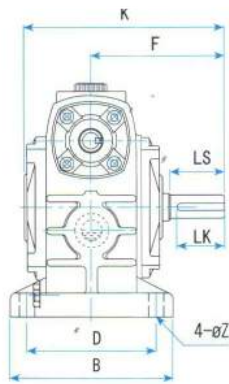

軸向選擇 Shaft Direction

尺寸表 Dimension

單位: m/m

減速比 RATIO	馬力 HP		腳座 FOOT STOCK					外形尺寸 OUTWARD SIZE								入力軸 INPUT SHAFT				出力軸 OUTPUT SHAFT				
	型號 MODEL	1/10~ 1/30	1/40~ 1/60	A	B	C	D	t	Z	E	F	G	H	I	J	K	L	HS	U	d	T _x V _x HK	LS	S	X
40	1/8		110	80	89	50	11	9	97	73	93	40	53	125	126	146	30	12	10	4x4x25	30	14	11	5x5x25
50	1/4	1/8	140	120	110	95	18	11	104	92	130	50	80	180	145	175	30	14	11.5	5x5x25	40	17	14	5x5x35
60	1/2	1/4	150	130	120	105	20	11	119	111	150	60	90	205	165	195	40	15	12	5x5x35	50	22	18	7x7x45
70	1	1/2	190	150	150	115	22	15	130	130	175	70	105	245	196	235	40	18	15	5x5x35	60	28	24	7x7x55
80	2	1	220	170	180	135	23	15	157	145	200	80	120	265	217	265	50	22	18	7x7x45	65	32	27.5	10x8x60
100	3	2	270	190	220	155	25	15	177	166	250	100	150	330	262	323	50	25	21	7x7x45	75	38	33.5	10x8x70
120	5	3	320	230	260	180	30	18	230	195	300	120	180	395	292	385	65	30	26	7x7x60	85	45	40.5	12x8x80
135	7 1/2	5	350	250	290	200	30	18	260	210	350	135	215	455	322	435	75	35	30.5	10x8x70	95	55	50	15x10x90
155	10	7 1/2	390	280	320	220	30	20	280	241	390	155	235	475	357	502	85	40	35.5	10x8x80	110	60	55	15x10x105
175	15	10	420	310	350	250	40	22	315	248	435	175	260	530	375	530	85	45	40.5	12x8x80	110	65	59	18x10x105
200	20	15	420	360	350	290	44	26.5	324	325	490	200	290	625	440	573	95	50	45.5	12x8x90	125	70	63	20x12x120

MODEL:TA



★ 50# ~ 350#

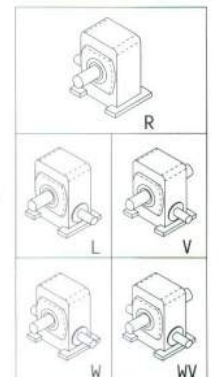
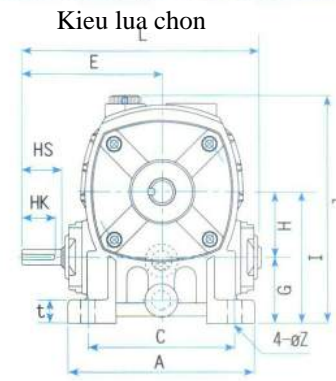
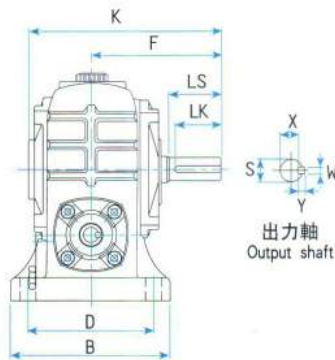

軸向選擇 Shaft Direction
單位: m/m

尺寸表 Dimension

減速比 RATIO	馬力 HP		腳座 FOOT STOCK					外形尺寸 OUTWARD SIZE								入力軸 INPUT SHAFT				出力軸 OUTPUT SHAFT				
	型號 MODEL	1/10~ 1/30	1/40~ 1/60	A	B	C	D	t	Z	E	F	G	H	I	J	K	L	HS	U	d	T _x V _x HK	LS	S	X
50	1/4	1/8	140	120	110	95	18	11	104	92	50	50	100	180	145	175	30	14	11.5	5x5x25	40	17	14	5x5x35
60	1/2	1/4	150	130	120	105	20	11	119	111	60	60	120	210	165	195	40	15	12	5x5x35	50	22	18	7x7x45
70	1	1/2	190	150	150	115	22	15	134	130	70	70	140	245	196	235	40	18	15	5x5x35	60	28	24	7x7x55
80	2	1	220	170	180	135	23	15	157	145	80	80	160	280	217	265	50	22	18	7x7x45	65	32	27.5	10x8x60
100	3	2	270	190	220	155	25	15	177	166	100	100	200	345	262	323	50	25	21	7x7x45	75	38	33.5	10x8x70
120	5	3	320	230	260	180	30	18	230	195	120	120	240	410	292	385	65	30	26	7x7x60	85	45	40.5	12x8x80
135	7 1/2	5	350	250	290	200	30	18	260	210	135	135	270	470	322	435	75	35	30.5	10x8x70	95	55	50	15x10x90
155	10	7 1/2	390	280	320	220	30	20	280	241	135	155	290	495	357	502	85	40	35.5	10x8x80	110	60	55	15x10x105
175	15	10	420	310	350	250	40	22	315	248	160	175	335	540	375	530	85	45	40.5	12x8x80	110	65	59	18x10x105
200	20	15	420	360	350	290	44	26.5	324	325	175	200	375	587	449	573	95	50	45.5	12x8x90	125	70	63	20x12x120
225	25	20	470	410	390	330	45	27	375	335	190	225	415	693	523	650	95	55	49	15x10x90	140	80	73	20x12x135
250	30	25	520	460	440	380	50	27	422	359	200	250	450	781	555	728	110	60	54	15x10x105	155	90	80	24x16x150
300	40	30	620	450	520	368	55	36	498	387	190	300	490	840	601	864	125	70	63	18x10x120	170	95	85	24x16x160
350	50	40	700	520	597	432	55	43	570	480	215	350	565	981	735	945	145	80	73	20x12x135	190	115	104	32x20x185

以上尺寸如有變動, 恕不另行通知

We regret that there will be no Sepcirate notification, if the above dimensions have been changed.

SINGLE REDUCTION WORM REDUCER SERIES 單段蝸輪減速機系列



MODEL: TMB



★ 50# ~ 175#

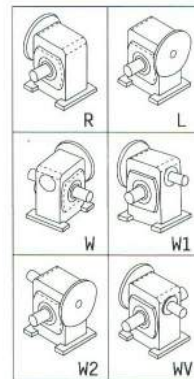
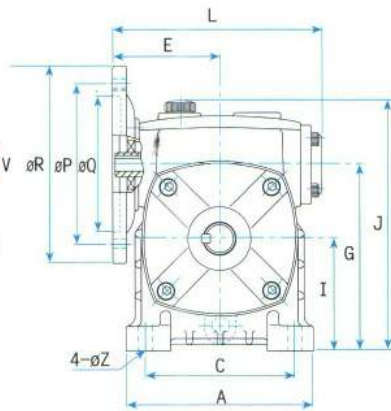
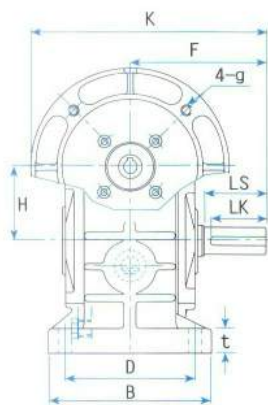

軸向選擇 Shaft Direction

尺寸表 Dimension

單位: m/m

減速比 RATIO	馬力 HP		腳座 FOOT STOCK					外形尺寸 OUTWARD SIZE							馬達盤 IEC MOTOR FLANGE				入力孔 INPUT BORE			出力軸 OUTPUT SHAFT					
	型號 MODEL	1/10~ 1/30	1/40~ 1/60	A	B	C	D	t	Z	E	F	G	H	I	J	K	L	P	Q	R	g	V	T	U	LS	S	X
50	1/4	1/8	140	120	110	95	18	11	81	92	130	50	80	210	175	149	130	110	160	M8	12.5	4	11	40	17	14	5x5x35
60	1/2	1/4	150	130	120	105	20	11	86	111	150	60	90	230	190	153	130	110	160	M8	12.5 16	4 5	11 14	50	22	18	7x7x45
70	1	1/2	190	150	150	115	22	15	105	130	175	70	105	255 275	210 230	195	130	110	160	M8 M10	16 21.5	5 6	14 19	60	28	24	7x7x55
80	2	1	220	170	180	135	23	15	114	145	200	80	120	300	245	221	165	130	200	M10	21.5 27	6 8	19 24	65	32	27.5	10x8x60
100	3	2	270	190	220	155	25	15	144	166	250	100	150	350 375	270 295	277	165	130	200	M10 M12	27 31	8	24 28	75	38	33.5	10x8x70
120	5	3	320	230	260	180	30	18	168	195	300	120	180	425	315	319	215	180	250	M12	31	8	28	85	45	40.5	12x8x80
135	7 1/2	5	350	250	290	200	30	18	187	210	350	135	215	475 500	335 360	362	215	180	250	M12 M12	31 41	8 10	28 38	95	55	50	15x10x90
155	10	7 1/2	390	280	320	220	30	20	206	241	390	155	235	540	391	406	265	230	300	M12	41	10	38	110	60	55	15x10x105
175	15	10	420	310	350	250	40	22	236	248	435	175	260	585 610	398 423	456	265	230	300	M12 M16	41 45	10 12	38 42	110	65	59	18x10x105
200	20	15	420	360	350	290	44	26.5	283	325	490	200	290	665	510	538	300	250	350	M16	45	12	42	125	70	63	20x12x120

MODEL: TMA



★ 60# ~ 155#

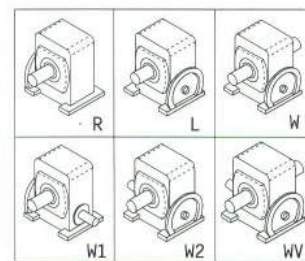
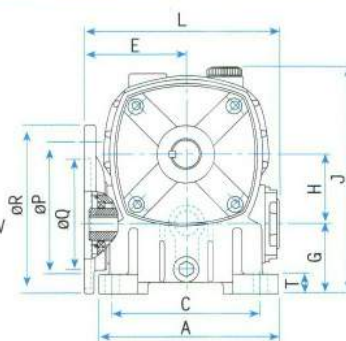
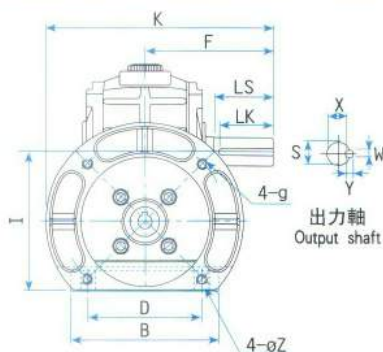

軸向選擇 Shaft Direction

尺寸表 Dimension

單位: m/m

減速比 RATIO	馬力 HP		腳座 FOOT STOCK					外形尺寸 OUTWARD SIZE							馬達盤 IEC MOTOR FLANGE				入力孔 INPUT BORE			出力軸 OUTPUT SHAFT					
	型號 MODEL	1/10~ 1/30	1/40~ 1/60	A	B	C	D	t	Z	E	F	G	H	I	J	K	L	P	Q	R	g	V	T	U	LS	S	X
60	1/2	1/4	150	130	120	105	20	11	86	111	60	60	120	210	190	153	130	110	160	M8	12.5 16	4 5	11 14	50	22	18	7x7x45
70	1	1/2	190	150	150	115	22	15	105	130	70	70	140	245	210 230	195	130	110	160	M8 M10	16 21.5	5 6	14 19	60	28	24	7x7x55
80	2	1	220	170	180	135	23	15	114	145	80	80	160	280	245	221	165	130	200	M10	21.5 27	6 8	19 24	65	32	27.5	10x8x60
100	3	2	270	190	220	155	25	15	144	166	100	100	200	345	270 295	277	165	130	200	M10 M12	27 31	8	24 28	75	38	33.5	10x8x70
120	5	3	320	230	260	180	30	18	168	195	120	120	240	410	315	319	215	180	250	M12	31	8	28	85	45	40.5	12x8x80
135	7 1/2	5	350	250	290	200	30	18	187	210	135	135	270	470	335 360	362	215	180	250	M12	31 41	8 10	28 38	95	55	50	15x10x90
155	10	7 1/2	390	280	320	220	30	20	206	241	135	155	290	495	391	406	265	230	300	M12	41	10	38	110	60	55	15x10x105
175	15	10	420	310	350	250	40	22	235	248	140	175	315	540	398 423	460	265	230	300	M12 M16	41 45	10 12	38 42	110	65	59	18x10x105

以上尺寸如有變動，恕不另行通知

We regret that there will be no separate notification, if the above dimensions have been changed.



SINGLE REDUCTION WORM REDUCER SERIES 單段蝸輪減速機系列

MODEL:TEU



★ 40# ~ 175#

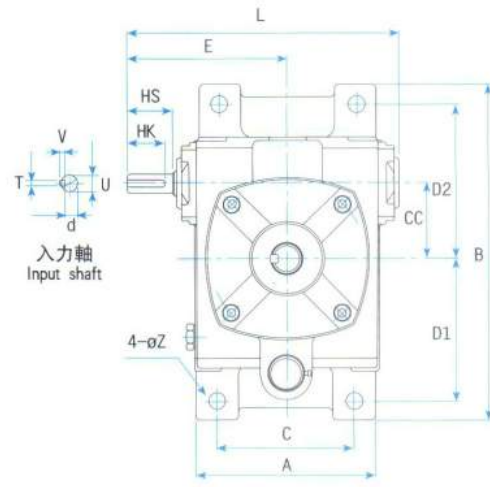
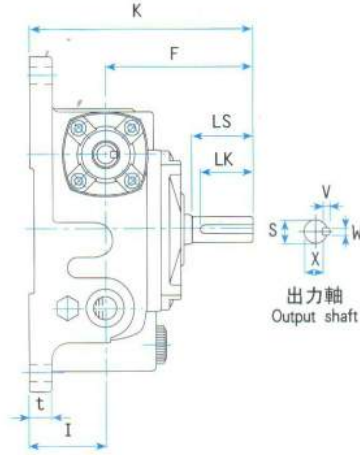

軸向選擇
Shaft Direction

尺寸表 Dimension

單位: m/m

減速比 RATIO	馬力 HP		腳座 FOOT STOCK						外形尺寸 OUTWARD SIZE						入力軸 INPUT SHAFT				出力軸 OUTPUT SHAFT					
	型號 MODEL	1/10~ 1/30	1/40~ 1/60	A	B	C	D1	D2	t	Z	E	F	H	I	K	L	HS	U	d	TxVxHK	LS	S	X	WxYxLK
40	1/8			94	182	70	75	85	14	9	86	80	40	45	125	139.5	25	12	10	4x4x25	30	14	11	5x5x25
50	1/4	1/8		120	220	90	93	102	18	11	104	92	50	50	142	175	30	14	11.5	5x5x25	40	17	14	5x5x35
60	1/2	1/4		130	262	100	105	120	20	11	119	111	60	55	166	195	40	15	12	5x5x35	50	22	18	7x7x45
70	1	1/2		160	298	120	120	135	22	15	134	130	70	65	195	235	40	18	15	5x5x35	60	28	24	7x7x55
80	2	1		180	320	140	130	150	23	15	157	145	80	70	215	265	50	22	18	7x7x45	65	32	27.5	10x8x60
100	3	2		226	380	190	155	180	25	15	177	166	100	90	265	323	50	25	21	7x7x45	75	38	33.5	10x8x70
120	5	3		266	450	220	185	215	30	18	230	195	120	100	295	385	65	30	26	7x7x60	85	45	40.5	12x8x80
135	7 1/2	5		306	495	260	210	235	30	18	260	210	135	110	320	435	75	35	30.5	10x8x70	95	55	50	15x10x90
155	10	7 1/2		350	460	290	145	265	30	20	280	241	155	140	381	502	85	40	35.5	10x8x80	110	60	55	15x10x105
175	15	10		385	520	320	167	293	40	22	315	248	175	150	398	530	85	45	40.5	12x8x80	110	65	59	18x10x105

MODEL:TEU

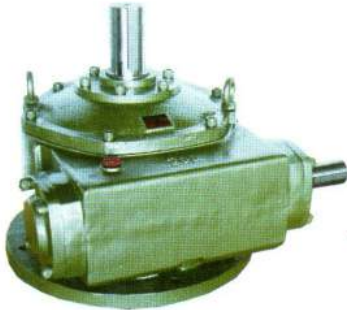

★ 200# ~ 350#

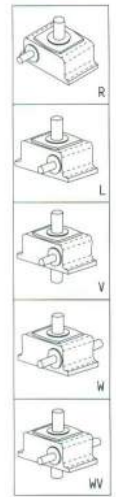
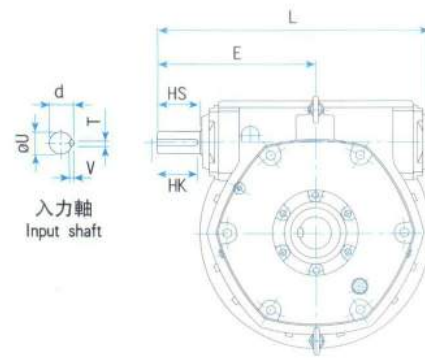
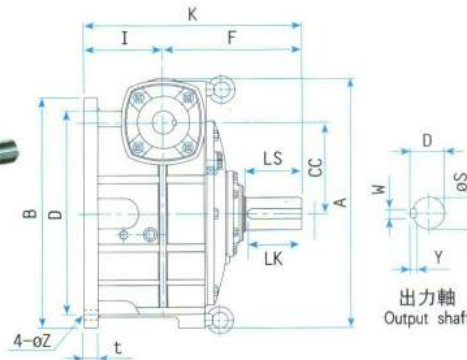

軸向選擇
Shaft Direction

尺寸表 Dimension

單位: m/m

減速比 RATIO	馬力 HP		腳座 FOOT STOCK						外形尺寸 OUTWARD SIZE						入力軸 INPUT SHAFT				出力軸 OUTPUT SHAFT			
	型號 MODEL	1/10~ 1/30	1/40~ 1/60	A	B	D	t	Z	E	F	I	K	L	CC	HS	U	d	TxVxHK	LS	S	D	WxYxLK
200	20	15		558	510	450	32	22	352	311	175	486	604	200	95	50	53	12x8x90	125	70	75	20x12x120
225	25	20		622	580	510	35	27	375	335	190	525	650	225	95	55	59	15x10x90	140	80	85	20x12x135
250	30	25		675	640	570	35	27	422	359	200	559	728	250	110	60	64	15x10x105	155	90	96.5	24x16x150
300	40	30		800	750	660	38	36	498	387	235	622	864	300	125	70	73	18x10x120	170	95	101.5	24x16x160
350	50	40		945	880	780	38	43	570	480	290	770	945	350	145	80	85	20x12x135	190	115	124	32x20x185

以上尺寸如有變動, 恕不另行通知

We regret that there will be no Sepcirate notification, if the above dimensions have been changed.

SINGLE REDUCTION WORM REDUCER SERIES 單段蝸輪減速機系列



MODEL:TED



★ 50# ~ 175#

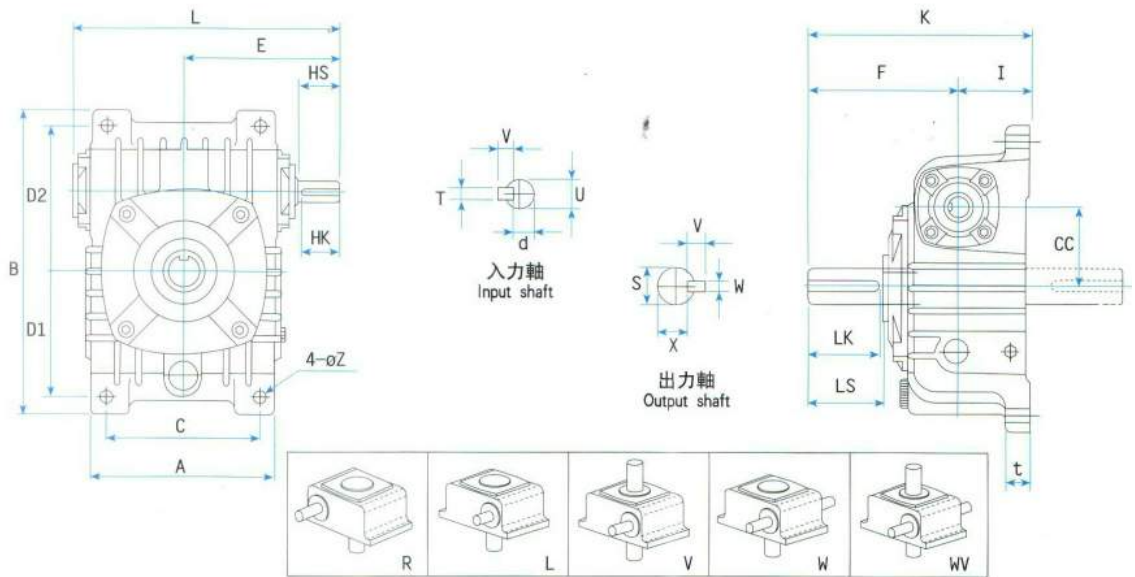

軸向選擇 Shaft Direction

單位: m/m

尺寸表 Dimension

減速比 RATIO	馬力 HP		腳座 FOOT STOCK							外形尺寸 OUTWARD SIZE							入力軸 INPUT SHAFT				出力軸 OUTPUT SHAFT			
	型號 MODEL	1/10~ 1/30	1/40~ 1/60	A	B	C	D1	D2	t	Z	E	F	H	I	K	L	HS	U	d	T _x V _x HK	LS	S	X	W _x Y _x LK
50	1/4	1/8	120	220	90	93	102	18	11	104	92	50	50	142	175	30	14	11.5	5x5x25	40	17	14	5x5x35	
60	1/2	1/4	130	262	100	105	120	20	11	119	111	60	55	166	195	40	15	12	5x5x35	50	22	18	7x7x45	
70	1	1/2	160	298	120	120	135	22	15	134	130	70	65	195	235	40	18	15	5x5x35	60	28	24	7x7x55	
80	2	1	180	320	140	130	150	23	15	157	145	80	70	215	265	50	22	18	7x7x45	65	32	27.5	10x8x60	
100	3	2	226	380	190	155	180	25	15	177	166	100	90	265	323	50	25	21	7x7x45	75	38	33.5	10x8x70	
120	5	3	266	450	220	185	215	30	18	230	195	120	100	295	385	65	30	26	7x7x60	85	45	40.5	12x8x80	
135	7 1/2	5	306	495	260	210	235	30	18	260	210	135	110	320	435	75	35	30.5	10x8x70	95	55	50	15x10x90	
155	10	7 1/2	350	460	290	145	265	30	20	280	241	155	140	381	502	85	40	35.5	10x8x80	110	60	55	15x10x105	
175	15	10	385	520	320	167	293	40	22	315	248	175	150	398	530	85	45	40.5	12x8x80	110	65	59	18x10x105	

MODEL:TED



★ 200# ~ 350#

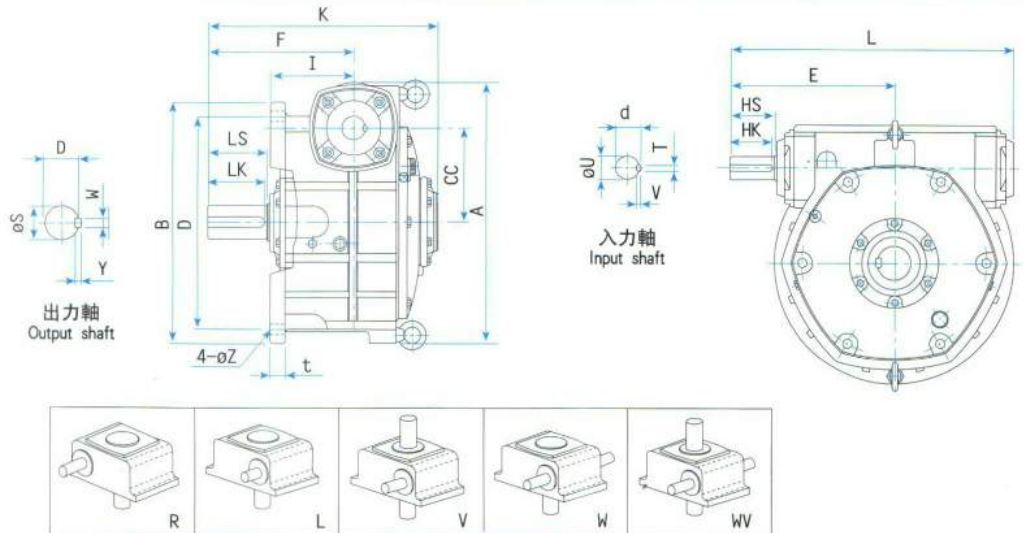

軸向選擇 Shaft Direction

單位: m/m

尺寸表 Dimension

減速比 RATIO	馬力 HP		腳座 FOOT STOCK					外形尺寸 OUTWARD SIZE							入力軸 INPUT SHAFT				出力軸 OUTPUT SHAFT			
	型號 MODEL	1/10~ 1/30	1/40~ 1/60	A	B	D	t	Z	E	F	I	K	L	CC	HS	U	d	T _x V _x HK	LS	S	D	W _x Y _x LK
200	20	15	558	510	450	32	22	352	311	175	486	604	200	95	50	53	12x8x90	125	70	75	20x12x120	
225	25	20	622	580	510	35	27	375	335	190	525	650	225	95	55	59	15x10x90	140	80	85	20x12x135	
250	30	25	675	640	570	35	27	422	359	200	559	728	250	110	60	64	15x10x105	155	90	96.5	24x16x150	
300	40	30	800	750	660	38	36	498	387	235	622	864	300	125	70	73	18x10x120	170	95	101.5	24x16x160	
350	50	40	945	880	780	38	43	570	480	290	770	945	350	145	80	85	20x12x135	190	115	124	32x20x185	

以上尺寸如有變動，恕不另行通知
We regret that there will be no separate notification, if the above dimensions have been changed.

SINGLE REDUCTION WORM REDUCER SERIES

單段蝸輪減速機系列

MODEL: TN $\frac{U}{D}$

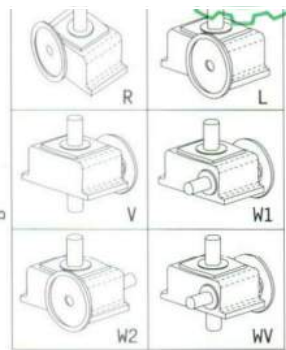
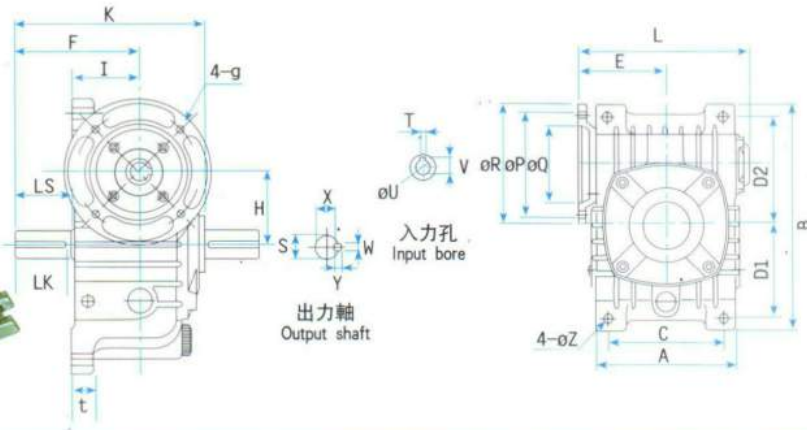

軸向選擇 Shaft Direction

單位: m/m

尺寸表 Dimension

減速比 RATIO	馬力 HP		腳座 FOOT STOCK							外形尺寸 OUTWARD SIZE							馬達盤 IEC MOTOR FLANGE				入力孔 INPUT BORE			出力軸 OUTPUT SHAFT			
	型號 MODEL	1/10~ 1/30	1/40~ 1/60	A	B	C	D1	D2	t	Z	E	F	H	I	K	L	P	Q	R	g	V	T	U	LS	S	X	WxYxLK
50	1/4	1/8	120	220	90	93	102	18	11	81	92	50	50	148	149	130	110	160	M8	12.5	4	11	40	17	14	5x5x35	
60	1/2	1/4	130	262	100	105	120	20	11	86	111	60	55	165	153	130	110	160	M8	12.5 16	4 5	11 14	50	22	18	7x7x45	
70	1	1/2	160	298	120	120	135	22	15	105	130	70	65	195	195	130 165	110 130	160 200	M8 M10	16 21.5	5 6	14 19	60	28	24	7x7x55	
80	2	1	180	320	140	130	150	23	15	114	145	80	70	210	221	165	130	200	M10	21.5 27	6 8	19 24	65	32	27.5	10x8x60	
100	3	2	226	380	190	155	180	25	15	144	166	100	90	260	276	165 215	130 180	200 250	M10 M12	27 31	8 8	24 28	75	38	33.5	10x8x70	
120	5	3	266	450	220	185	215	30	18	168	195	120	100	290	319	215	180	250	M12	31	8	28	85	45	40.5	12x8x80	
135	7 1/2	5	306	495	260	210	235	30	18	187	210	135	110	324	362	215 265	180 230	250 300	M12 M12	31 41	8 10	28 38	95	55	50	15x10x90	
155	10	7 1/2	350	460	290	145	265	30	20	206	241	155	140	393	405	265	230	300	M12	41	10	38	110	60	55	15x10x105	
175	15	10	385	520	320	167	293	40	22	236	248	175	150	412	456	265 300	230 250	300 350	M12 M16	41 45	10 12	38 42	110	65	59	18x10x105	

MODEL: TBYM

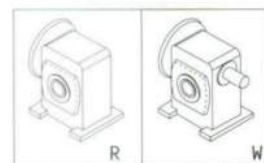
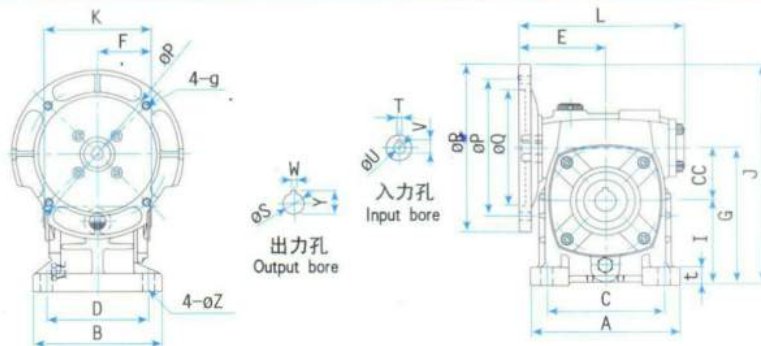

軸向選擇 Shaft Direction

尺寸表 Dimension

減速比 RATIO	馬力 HP		腳座 FOOT STOCK							外形尺寸 OUTWARD SIZE							馬達盤 IEC MOTOR FLANGE				入力孔 INPUT BORE			出力孔 OUTPUT BORE		
	型號 MODEL	1/10~ 1/30	1/40~ 1/60	A	B	C	D	t	Z	E	F	G	I	J	K	L	CC	P	Q	R	g	V	T	U	W	Y
50	1/4	1/8	140	120	110	95	18	11	81	52	130	80	210	104	149	50	130	110	160	M8	12.5	4	11	5	22	20
60	1/2	1/4	150	130	120	105	20	11	86	58	150	90	230	116	153	60	130	110	160	M8	12.5 16	4 5	11 14	7	28	25
70	1	1/2	190	150	150	115	22	15	105	67.5	175	105	255 275	135	195	70	130 165	110 130	160 200	M8 M10	16 21.5	5 6	14 19	7	33	30
80	2	1	220	170	180	135	23	15	114	75	200	120	300	150	221	80	165	130	200	M10	21.5 27	6 8	19 24	10	38	35
100	3	2	270	190	220	155	25	15	144	91	250	150	350 375	182	277	100	165 215	130 180	200 250	M10 M12	27 31	8 8	24 28	10	43	40
120	5	3	320	230	260	180	30	18	168	107.5	300	180	425	215	319	120	215	180	250	M12	31	8	28	12	48	45
135	7 1/2	5	350	250	290	200	30	18	187	118	350	215	475 500	226	362	135	215 265	180 230	250 300	M12	31 41	8	28 38	15	60	55
155	10	7 1/2	390	280	320	220	30	20	206	126	390	235	540	276	406	155	265	230	300	M12	41	10	38	15	70	65
175	15	10	420	310	350	250	40	22	236	132	435	260	585 610	280	456	175	265 300	230 250	300 350	M12 M16	41 45	10 12	38 42	18	95	90
200	20	15	420	360	350	290	44	26.5	283	282	490	290	665	305	538	200	300	250	350	M16	45	12	42	18	100	95

單位: m/m

SINGLE REDUCTION WORM REDUCER SERIES 單段蝸輪減速機系列



MODEL: TBY



★ 50# ~ 200#

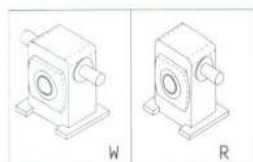

軸向選擇 Shaft Direction

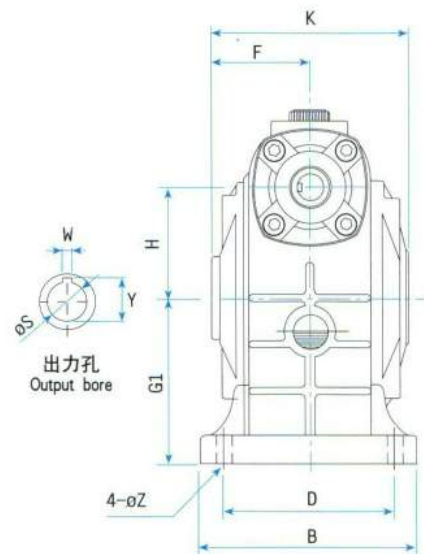
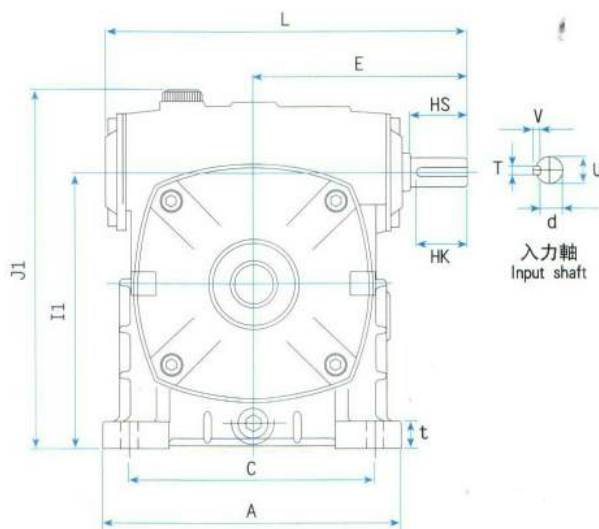

MODEL: TAY



★ 50# ~ 200#

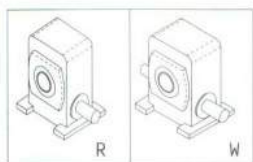

軸向選擇 Shaft Direction

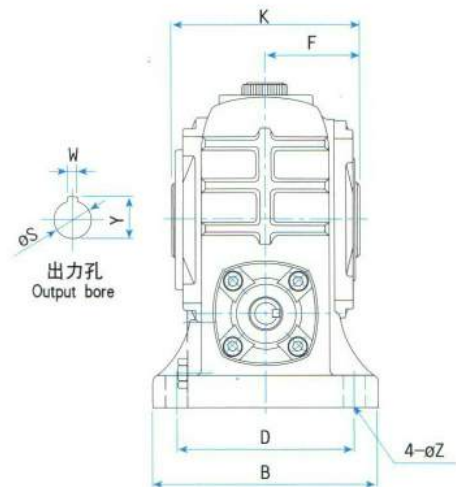
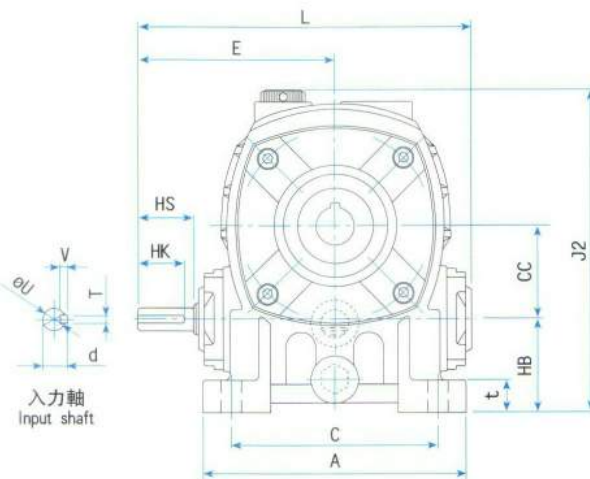

尺寸表 Dimension

單位: m/m

減速比 RATIO	馬力 HP		腳座 FOOT STOCK					外形尺寸 OUTWARD SIZE							輸入軸 INPUT SHAFT				出力孔 OUTPUT BORE					
			A	B	C	D	t	Z	E	F	G ₁	H	I ₁	J ₁	J ₂	K	L	HS	U	d	TxVxHK	W	Y	S
50	1/4	1/8	140	120	110	95	18	11	109	52	80	50	130	180	180	104	175	30	14	11.5	5x5x25	5	22	20
60	1/2	1/4	150	130	120	105	20	11	119	58	90	60	150	205	210	116	195	40	15	12	5x5x35	7	28	25
70	1	1/2	190	150	150	115	22	15	130	67.5	105	70	175	245	245	135	235	40	18	15	5x5x35	7	33	30
80	2	1	220	170	180	135	23	15	157	75	120	80	200	265	280	150	265	50	22	18	7x7x45	10	38	35
100	3	2	270	190	220	155	25	15	177	91	150	100	250	330	345	182	323	50	25	21	7x7x45	10	43	40
120	5	3	320	230	260	180	30	18	230	107.5	180	120	300	395	410	215	385	65	30	26	7x7x60	12	48	45
135	7 1/2	5	350	250	290	200	30	18	260	113	215	135	350	455	470	226	435	75	35	30.5	10x8x70	15	60	55
155	10	7 1/2	390	280	320	220	30	20	280	135	235	155	390	475	495	276	502	85	40	35.5	10x8x80	15	70	65
175	15	10	420	310	350	250	40	22	315	172	260	175	435	530	540	280	530	85	45	40.5	12x8x80	18	95	90
200	20	15	420	360	350	290	44	26.5	324	152.5	290	200	490	625	587	305	573	95	50	45.5	12x8x90	18	100	95

以上尺寸如有變動，恕不另行通知
We regret that there will be no separate notification, if the above dimensions have been changed.



SINGLE REDUCTION WORM REDUCER SERIES 單段蝸輪減速機系列

MODEL:TEA



★ 50# ~ 175#

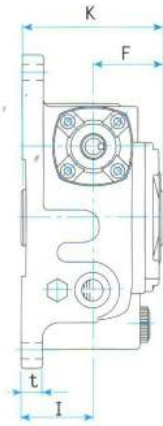

出力孔
Output bore



入力軸
Input shaft

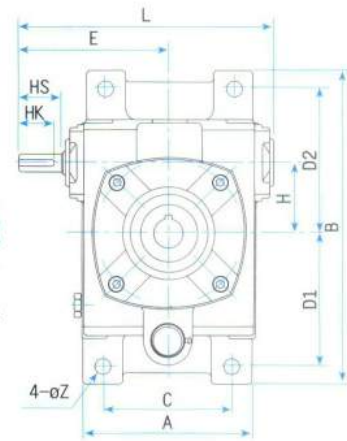

軸向選擇
Shaft Direction

單位: m/m

尺寸表 Dimension

減速比 RATIO	馬力 HP		腳座 FOOT STOCK								外形尺寸 OUTWARD SIZE							入力軸 INPUT SHAFT				出力孔 OUTPUT BORE		
	型號 MODEL	1/10~ 1/30	1/40~ 1/60	A	B	C	D1	D2	t	Z	E	F	H	I	K	L	HS	U	d	T _x V _x HK	W	Y	S	
50	1/4	1/8	120	220	90	93	102	18	11	104	52	50	50	102	175	30	14	11.5	5x5x25	5	22	20		
60	1/2	1/4	130	262	100	105	120	20	11	119	58	60	55	113	195	40	15	12	5x5x35	7	28	25		
70	1	1/2	160	298	120	120	135	22	15	134	67.5	70	65	132.5	235	40	18	15	5x5x35	7	33	30		
80	2	1	180	320	140	130	150	23	15	157	75	80	70	145	265	50	22	18	7x7x45	10	38	35		
100	3	2	226	380	190	155	180	25	15	177	91	100	90	181	323	50	25	21	7x7x45	10	43	40		
120	5	3	266	450	220	185	215	30	18	230	107.5	120	100	207.5	385	65	30	26	7x7x60	12	48	45		
135	7 1/2	5	306	495	260	210	235	30	18	260	113	135	110	223	435	75	35	30.5	10x8x70	15	60	55		
155	10	7 1/2	350	460	290	145	265	30	20	280	138	155	140	278	502	85	40	35.5	12x8x80	15	70	65		
175	15	10	385	520	320	167	293	40	22	315	142	175	150	280	530	85	45	40.5	12x8x80	18	95	90		

MODEL:TEAM



★ 50# ~ 175#

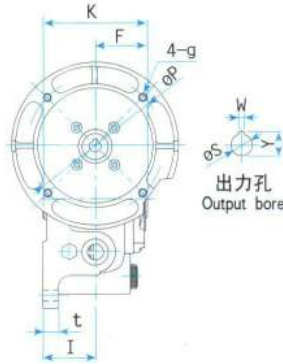

出力孔
Output bore



入力孔
Input bore

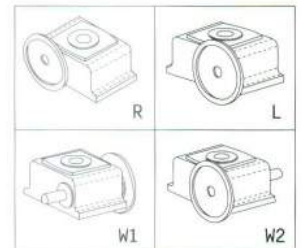
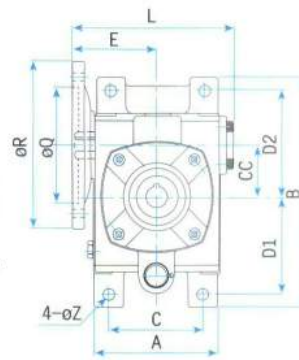

軸向選擇 Shaft Direction

單位: m/m

尺寸表 Dimension

減速比 RATIO	馬力 HP		腳座 FOOT STOCK								外形尺寸 OUTWARD SIZE							馬達盤 IEC MOTOR FLANGE				入力孔 INPUT BORE			出力孔 OUTPUT BORE		
	型號 MODEL	1/10~ 1/30	1/40~ 1/60	A	B	C	D1	D2	t	Z	E	F	I	K	L	CC	P	Q	R	g	V	T	U	W	Y	S	
50	1/4	1/8	120	220	90	93	102	18	11	81	52	50	102	149	50	130	110	160	M8	12.5	4	11	5	22	20		
60	1/2	1/4	130	262	100	105	120	20	11	86	58	55	113	153	60	130	110	160	M8	12.5 16	4 5	11 14	7	28	25		
70	1	1/2	160	298	120	120	135	22	15	105	67.5	65	132.5	195	70	130	110	160	M8 M10	16 21.5	5 6	14 19	7	33	30		
80	2	1	180	320	140	130	150	23	15	114	75	70	145	221	80	165	130	200	M10	21.5 27	6 8	19 24	10	38	35		
100	3	2	226	380	190	155	180	25	15	144	91	90	181	276	100	165 215	130 180	200 250	M10 M12	27 31	8	24 28	10	43	40		
120	5	3	266	450	220	185	215	30	18	168	107.5	100	207.5	319	120	215	180	250	M12	31	8	28	12	48	45		
135	7 1/2	5	306	495	260	210	235	30	18	187	113	110	223	362	135	215 265	180 230	250 300	M12 M12	31 41	8 10	28 38	15	60	55		
155	10	7 1/2	350	460	290	145	265	30	20	206	138	140	278	405	155	265	230	300	M12	41	10	38	15	70	65		
175	15	10	385	520	320	167	293	40	22	236	142	150	280	456	175	265 300	230 250	300 350	M12 M16	41 45	10 12	38 42	18	95	90		

以上尺寸如有變動, 恕不另行通知

We regret that there will be no separate notification, if the above dimensions have been changed.

SINGLE REDUCTION WORM REDUCER SERIES 單段蝸輪減速機系列



MODEL:TE

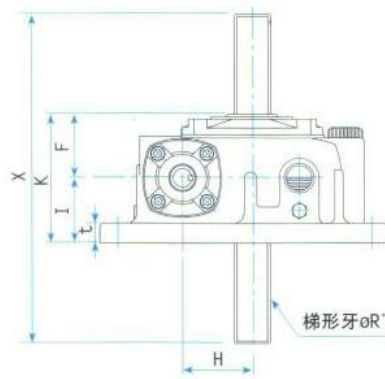

X:User deine

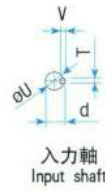

輸入軸
Input shaft

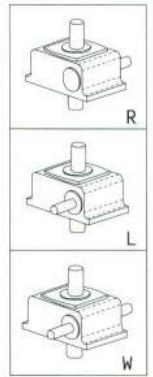
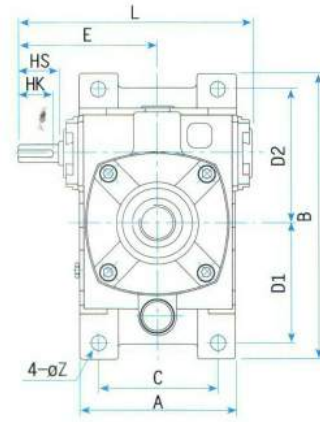

軸向選擇
Shaft Direction

尺寸表 Dimension

單位: m/m

減速比 RATIO	馬力 HP		腳座 FOOT STOCK							外形尺寸 OUTWARD SIZE							輸入軸 INPUT SHAFT				角牙 R'
	型號 MODEL	1/10~ 1/30	1/40~ 1/60	A	B	C	D1	D2	t	Z	E	F	H	I	K	L	HS	U	d	TxVxHK	
50	1/4			120	220	90	93	102	18	11	104	52	50	50	102	175	30	14	16.5	5x5x35	1"
60	1/2	1/4		130	262	100	105	120	20	11	119	58	60	55	113	195	40	15	17	5x5x35	1"
70	1	1/2		160	298	120	120	135	22	15	134	67.5	70	65	132.5	235	40	18	20	5x5x35	11/8"
80	2	1		180	320	140	130	150	23	15	157	75	80	70	145	265	50	22	25	7x7x45	11/4"
100	3	2		226	380	190	155	180	25	15	177	91	100	90	181	323	50	25	28	7x7x45	11/2"
120	5	3		266	450	220	185	215	30	18	230	107.5	120	100	207.5	385	65	30	33	7x7x60	2"
135	7 1/2	5		306	495	260	210	235	30	18	260	113	135	110	223	435	75	35	38.5	10x8x70	2"

MODEL:TNE

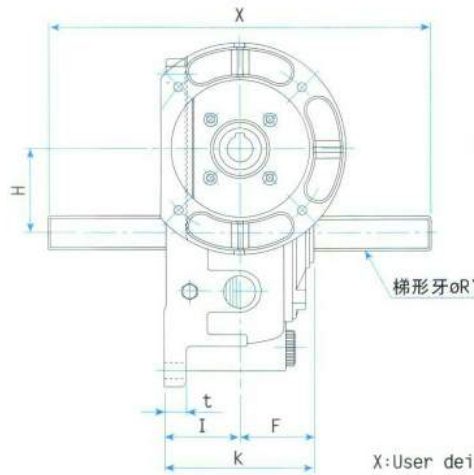

X:User deine



輸入孔
Input bore

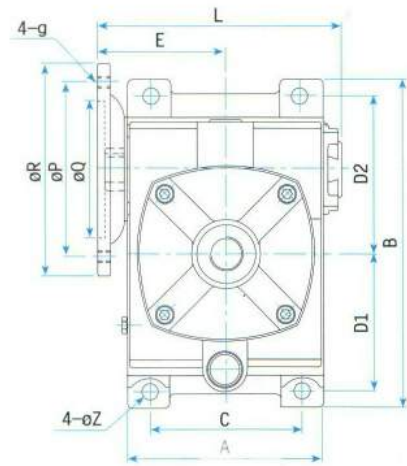

尺寸表 Dimension

單位: m/m

減速比 RATIO	馬力 HP		腳座 FOOT STOCK							外形尺寸 OUTWARD SIZE							馬達盤 IEC MOTOR FLANGE				輸入孔 INPUT BORE			角牙 R'
	型號 MODEL	1/10~ 1/30	1/40~ 1/60	A	B	C	D1	D2	t	Z	E	F	H	I	K	L	P	Q	R	g	V	T	U	
50	1/4			120	220	90	93	102	18	11	81	52	50	50	102	149	130	110	160	M8	12.5	4	11	1"
60	1/2	1/4		130	262	100	105	120	20	11	86	58	60	55	113	153	130	110	160	M8	12.5	4 [#]	11	1"
70	1	1/2		160	298	120	120	135	22	15	105	67.5	70	65	132.5	195	130	110	160	M8	16	5	14	11/8"
80	2	1		180	320	140	130	150	23	15	114	75	80	70	145	221	165	130	200	M10	21.5	6	19	11/4"
100	3	2		226	380	190	155	180	25	15	144	91	100	90	181	276	165	130	200	M10	27	8	24	11/2"
120	5	3		266	450	220	185	215	30	18	168	107.5	120	100	207.5	319	215	180	250	M12	31	8	28	2"
135	7 1/2	5		306	495	260	210	235	30	18	187	113	135	110	223	362	215	180	250	M12	31	8	28	2"
																	265	230	300	M12	41	10	38	2"

以上尺寸如有變動，恕不另行通知

We regret that there will be no Separate notification, if the above dimensions have been changed.



SINGLE REDUCTION WORM REDUCER SERIES 單段蝸輪減速機系列

MODEL:TYB

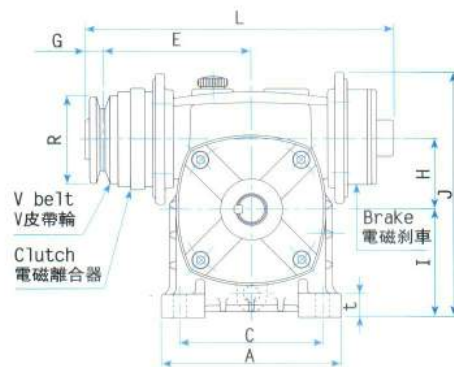
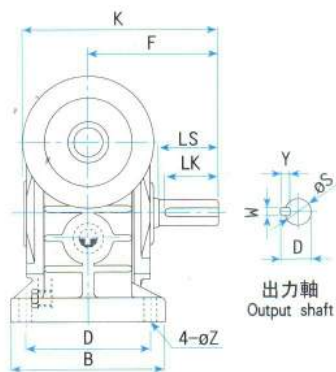

尺寸表 Dimension

電磁剎車/離合器定格電壓DC 24V
Electric-magnetic brake/rated voltage of clutch

單位: m/m

型號 MODEL	容量 KG	馬力 HP	減速比 RATIO	腳座 FOOT STOCK							外形尺寸 OUTWARD SIZE							出力軸 OUTPUT SHAFT				
				A	B	C	D	t	Z	E	F	G	H	I	J	K	L	R	LS	S	D	WxYxLK
50	0.6	1/4	10~30	140	120	110	95	18	11	108	98	20	50	80	180	149	226	76	40	17	19	5x5x35
60	0.6		40~60	150	130	120	105	20	11	116	110	20	60	90	190	164	250	76	50	22	25	7x7x45
60	1.5	1/2	10~30	150	130	120	105	20	11	119	110	20	60	90	205	164	254	102	50	22	25	7x7x45
70	1.5		40~60	190	150	150	115	22	15	132	130	20	70	105	230	193	287	102	60	28	31	7x7x55
70	2.5	1	10~30	190	150	150	115	22	15	145	130	23	70	105	238	193	322	127	60	28	31	7x7x55
80	2.5		40~60	220	170	180	135	23	15	152	140	23	80	120	270	210	338	127	65	32	35.5	10x8x60
80	2.5	2	10~30	220	170	180	135	23	15	152	140	23	80	120	270	210	338	127	65	32	35.5	10x8x60
100	5	2	40~60	270	190	220	155	25	15	214	170	23	100	150	332	260	419	127	75	38	41.5	10x8x70
100	5	3	10~30	270	190	220	155	25	15	214	170	23	100	150	332	260	419	127	75	38	41.5	10x8x70
120	8	3 5	40~60 10~30	320	230	260	180	30	18	227	190	32	120	180	405	315	504	210	85	45	48.5	12x8x80

MODEL:TYU

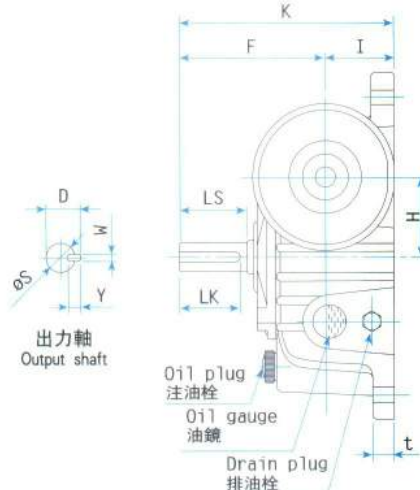
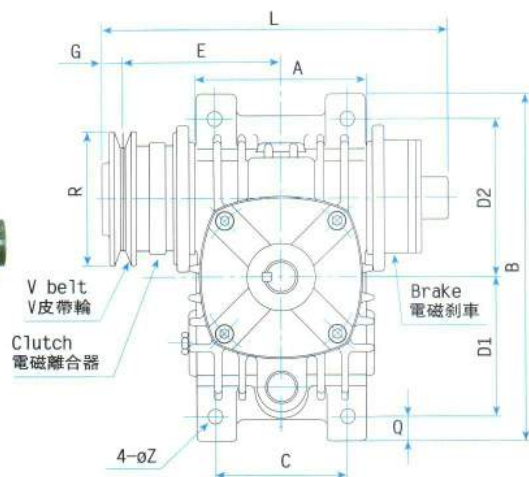

尺寸表 Dimension

電磁剎車/離合器定格電壓DC 24V
Electric-magnetic brake/rated voltage of clutch

單位: m/m

型號 MODEL	容量 KG	馬力 HP	減速比 RATIO	腳座 FOOT STOCK							外形尺寸 OUTWARD SIZE							出力軸 OUTPUT SHAFT				
				A	B	C	D1	D2	t	Z	E	F	G	H	I	K	L	R	LS	S	D	WxYxLK
50	0.6	1/4	10~30	120	220	90	102	93	18	11	108	98	20	50	50	148	236	76	40	17	19	5x5x35
60	0.6		40~60	130	262	100	120	105	20	11	116	110	20	60	55	165	250	76	50	22	25	7x7x45
60	1.5	1/2	10~30	130	262	100	120	105	20	11	119	110	20	60	55	165	254	102	50	22	25	7x7x45
70	1.5		40~60	160	298	120	135	120	22	15	132	130	20	70	65	195	287	102	60	28	31	7x7x55
70	2.5	1	10~30	160	298	120	135	120	22	15	145	130	23	70	65	195	322	127	60	28	31	7x7x55
80	2.5		40~60	180	320	140	150	130	23	15	152	140	23	80	70	210	338	127	65	32	35.5	10x8x60
80	2.5	2	10~30	180	320	140	150	130	23	15	152	140	23	80	70	210	338	127	65	32	35.5	10x8x60
100	5	2	40~60	226	380	190	180	155	25	15	214	170	23	100	90	260	419	127	75	38	41.5	10x8x70
100	5	3	10~30	226	380	190	180	155	25	15	214	170	23	100	90	260	419	127	75	38	41.5	10x8x70

以上尺寸如有變動，恕不另行通知

We regret that there will be no Separate notification, if the above dimensions have been changed.

SINGLE REDUCTION WORM REDUCER SERIES 單段蝸輪減速機系列



MODEL:TC

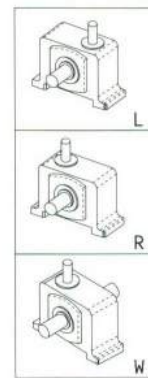
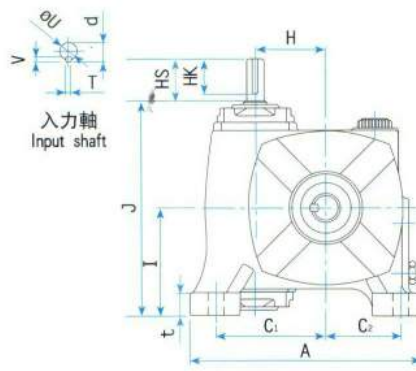
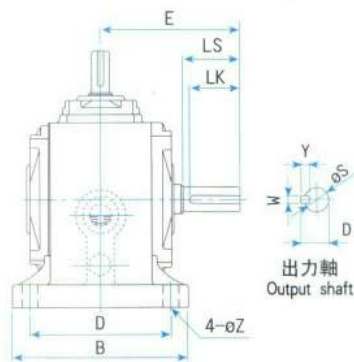

軸向選擇
Shaft Direction

★ 50# ~ 135#

尺寸表 Dimension

單位: m/m

減速比 RATIO	馬力 HP		腳座 FOOT STOCK							外形尺寸 OUTWARD SIZE				輸入軸 INPUT SHAFT				輸出軸 OUTPUT SHAFT			
	型號 MODEL	1/10~ 1/30	1/40~ 1/60	A	B	C1	C2	D	t	Z	E	H	I	J	HS	U	d	TxVxHK	LS	S	X
50	1/4	1/8	161	125	77	53	100	15	11	92	50	76	145	30	14	11.5	5x5x25	40	17	14	5x5x35
60	1/2	1/4	205	130	98	67	105	20	11	111	60	90	170	40	15	12	5x5x35	50	22	18	7x7x45
70	1	1/2	230	150	115	75	120	20	15	130	70	95	190	40	18	15	5x5x35	50	28	24	7x7x55
80	2	1	264	160	125	90	125	20	15	145	80	105	212	50	22	18	7x7x45	65	32	27.5	10x8x60
100	3	2	310	195	150	100	155	25	15	166	100	135	262	50	25	21	7x7x45	75	38	33.5	10x8x60
120	5	3	360	230	180	120	180	28	18	175	120	160	326	65	30	26	7x7x60	85	45	40.5	12x8x80
135	7 1/2	5	390	250	200	130	200	30	18	210	135	170	353	75	35	30.5	10x8x70	95	55	50	15x10x90

MODEL:TNC

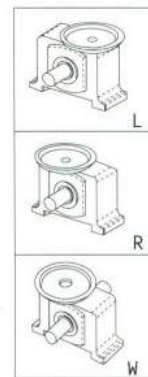
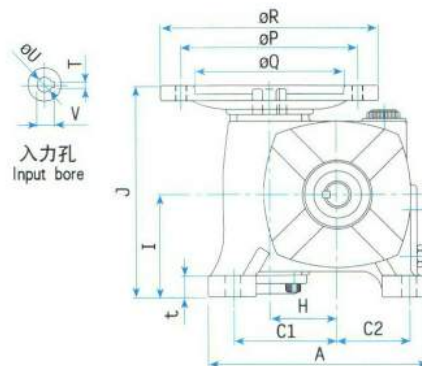
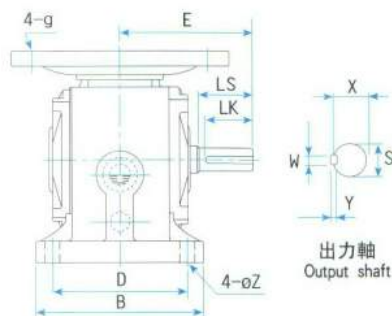

軸向選擇
Shaft Direction

★ 50# ~ 135#

尺寸表 Dimension

單位: m/m

減速比 RATIO	馬力 HP		腳座 FOOT STOCK							外形尺寸 OUTWARD SIZE				馬達盤 IEC MOTOR FLANGE				入力孔 INPUT BORE			出力軸 OUTPUT SHAFT			
	型號 MODEL	1/10~ 1/30	1/40~ 1/60	A	B	C1	C2	D	t	Z	E	H	I	J	P	Q	R	g	V	T	U	LS	S	X
50	1/4	1/8	161	125	77	53	100	15	11	92	50	76	163	130	110	160	M8	12.5	4	11	40	17	14	5x5x35
60	1/2	1/4	205	130	98	67	105	20	11	111	60	90	175	130	110	160	M8	12.5 16	4 5	11 14	50	22	18	7x7x45
70	1	1/2	230	150	115	75	120	20	15	130	70	95	196	130 165	110 130	160 200	M8 M10	16 21.5	5 6	14 19	60	28	24	7x7x55
80	2	1	264	160	125	90	125	20	15	145	80	105	225	165	130	200	M10	21.5 27	6 8	19 24	65	32	27.5	10x8x60
100	3	2	310	195	150	100	155	25	15	166	100	135	280	165 215	130 180	200 250	M10 M12	27 31	8	24 28	75	38	33.5	10x8x70
120	5	3	360	230	180	120	180	28	18	195	120	160	320	215	180	250	M12	31	8	28	85	45	40.5	12x8x80
135	7 1/2	5	390	250	200	130	200	30	18	210	135	170	353	215 265	180 230	250 300	M12	31 41	8 10	28 38	95	55	50	15x10x90

以上尺寸如有變動，恕不另行通知
We regret that there will be no separate notification, if the above dimensions have been changed.



SINGLE REDUCTION WORM REDUCER SERIES 單段蝸輪減速機系列

MODEL:TCY



★ 70# ~ 135#

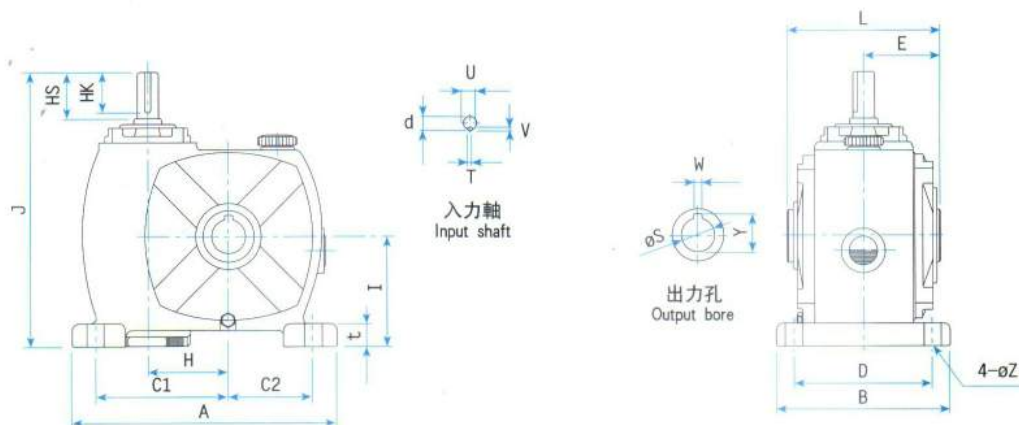

尺寸表 Dimension

單位: m/m

減速比 RATIO	馬力 HP	腳座 FOOT STOCK							外形尺寸 OUTWARD SIZE							入力軸 INPUT SHAFT				出力孔 OUTPUT BORE		
		型號 MODEL	1/10~ 1/30	1/40~ 1/60	A	B	C1	C2	D	t	Z	E	H	I	J	L	HS	U	d	TxVxHK	W	Y
70	1	1/2	230	150	115	75	120	20	15	65	70	95	195	135	40	18	15	5x5x35	7	33	30	
80	2	1	264	160	125	90	125	20	15	70	80	105	216	150	50	22	18	7x7x45	10	38	35	
100	3	2	310	195	150	100	155	25	15	90	100	135	275	182	50	25	21	7x7x45	10	43	40	
120	5	3	360	230	180	120	180	28	18	100	120	160	326	215	65	30	26	7x7x60	12	48	45	
135	7 1/2	5	390	250	200	130	200	30	18	110	135	170	353	223	75	35	30	10x8x70	15	60	55	

MODEL:TNCY



★ 70# ~ 135#

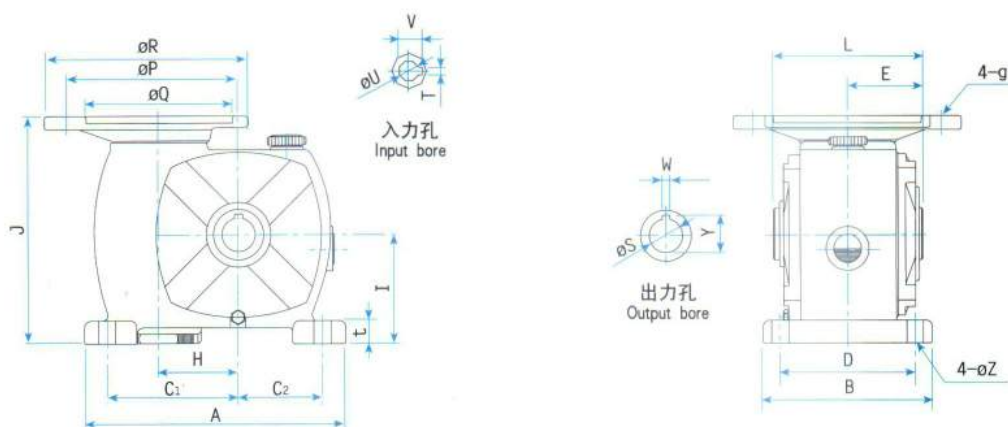

尺寸表 Dimension

單位: m/m

減速比 RATIO	馬力 HP	腳座 FOOT STOCK							外形尺寸 OUTWARD SIZE							馬達盤 IEC MOTOR FLANGE				入力軸 INPUT SHAFT				出力孔 OUTPUT BORE		
		型號 MODEL	1/10~ 1/30	1/40~ 1/60	A	B	C1	C2	D	t	Z	E	H	I	J	L	P	Q	R	g	V	T	U	W	Y	S
70	1	1/2	230	150	115	75	120	20	15	65	70	95	196	135	130	110	160	M8	16	5	14	7	33	30		
80	2	1	264	160	125	90	125	20	15	70	80	105	225	150	165	130	200	M10	21.5	6	19	10	38	35		
100	3	2	310	195	150	100	155	25	15	90	100	135	280	182	165	180	200	M10	27	8	24	10	43	40		
120	5	3	360	230	180	120	180	28	18	100	120	160	320	215	215	180	250	M12	31	8	28	12	48	45		
135	7 1/2	5	390	250	200	130	200	30	18	110	135	170	353	223	215	180	250	M12	31	8	28	15	60	55		

以上尺寸如有變動，恕不另行通知

We regret that there will be no separate notification, if the above dimensions have been changed.

DOUBLE REDUCTION WORM REDUCER SERIES 雙段蝸輪減速機系列



MODEL:TFA

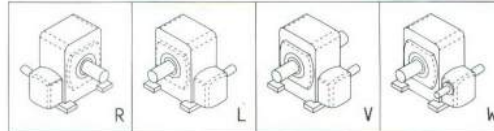
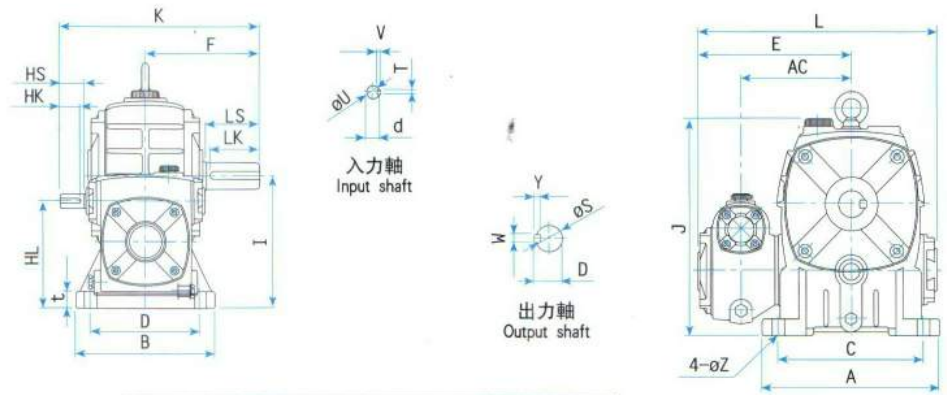

軸向選擇 Shaft Direction

單位: m/m

尺寸表 Dimension

減速比 RATIO	馬力 HP		腳座 FOOT STOCK					外形尺寸 OUTWARD SIZE							入力軸 INPUT SHAFT				出力軸 OUTPUT SHAFT					
	型號 MODEL	1/100-1/1000-1/900-1/3600	A	B	C	D	t	Z	E	F	I	J	K	L	AC	HL	HS	U	d	TxVxHK	LS	S	D	WxYxLK
60	1/16		150	130	120	105	20	11	144	111	120	210	198	222	100	92	25	12	13.5	4x4x25	50	22	25	7x7x45
70	1/8		190	150	150	115	22	15	165	130	140	245	216	260	121	110	30	12	14	4x4x25	60	28	31	7x7x55
80	1/4		220	170	180	135	23	15	188	145	160	280	245	295	136	130	30	14	16.5	5x5x25	65	32	35.5	10x8x60
100	1/2	1/4	270	190	220	155	25	15	214	166	200	345	290	346	158	160	40	15	17	5x5x35	75	38	41.5	10x8x70
120	1	1/2	320	230	260	180	30	18	248	195	240	410	330	407	185	190	40	18	20	5x5x35	85	45	48.5	12x8x80
135	2	1	350	250	290	200	30	18	290	210	270	470	375	471	219	215	50	22	25	7x7x45	95	55	60	15x10x90
155	3	2	390	280	320	220	30	20	348	241	290	495	443	547	258	235	50	25	28	7x7x45	110	60	65	15x10x105
175	5	3	420	310	350	250	40	22	393	248	315	540	493	623	290	280	65	30	33	7x7x60	110	65	69	18x10x105

MODEL:TFAM

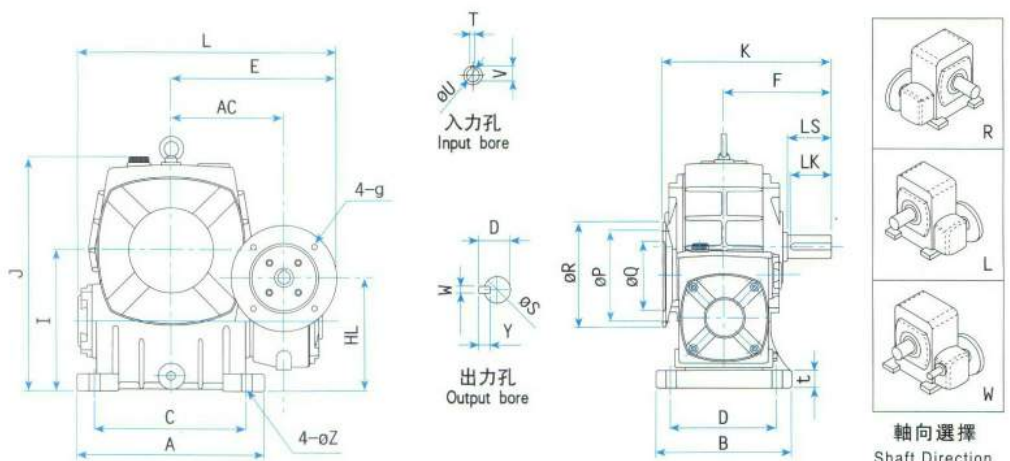

軸向選擇
Shaft Direction

單位: m/m

尺寸表 Dimension

減速比 RATIO	馬力 HP		腳座 FOOT STOCK					外形尺寸 OUTWARD SIZE							馬達盤 IEC MOTOR FLANGE				入力孔 INPUT BORE			出力軸 OUTPUT SHAFT					
	型號 MODEL	1/100-1/1000-1/900-1/3600	A	B	C	D	t	Z	E	F	I	J	K	L	AC	HL	P	Q	R	g	V	T	U	LS	S	D	WxYxLK
80	1/4		220	170	180	135	23	15	216	145	160	280	221	324	136	130	130	110	160	M8	12.5	4	11	65	32	35.5	10x8x60
100	1/2	1/4	270	190	220	155	25	15	238	166	200	345	256	371	158	160	130	110	160	M8	12.5	4	11	75	38	41.5	10x8x70
120	1	1/2	320	230	260	180	30	18	265 285	195	240	410	291	424 444	185	190	130	110	160	M8 M10	16 21.5	5 6	14 19	85	45	48.5	12x8x80
135	2	1	350	250	290	200	30	18	319	210	270	470	330	500	219	215	165	130	200	M10	21.5 27	6 8	19 24	95	55	60	15x10x90
155	3	2	390	280	320	220	30	20	358 383	241	290	495	397	557 582	258	235	165	130	200	M10 M12	27 31	8	24 28	110	60	65	15x10x105
175	5	3	420	310	350	250	40	22	415	248	315	540	426	645	290	280	215	180	250	M12	31	8	28	110	65	69	18x10x105

以上尺寸如有變動，恕不另行通知
We regret that there will be no separate notification, if the above dimensions have been changed.



DOUBLE REDUCTION WORM REDUCER SERIES 雙段蝸輪減速機系列

MODEL: TH_D^U

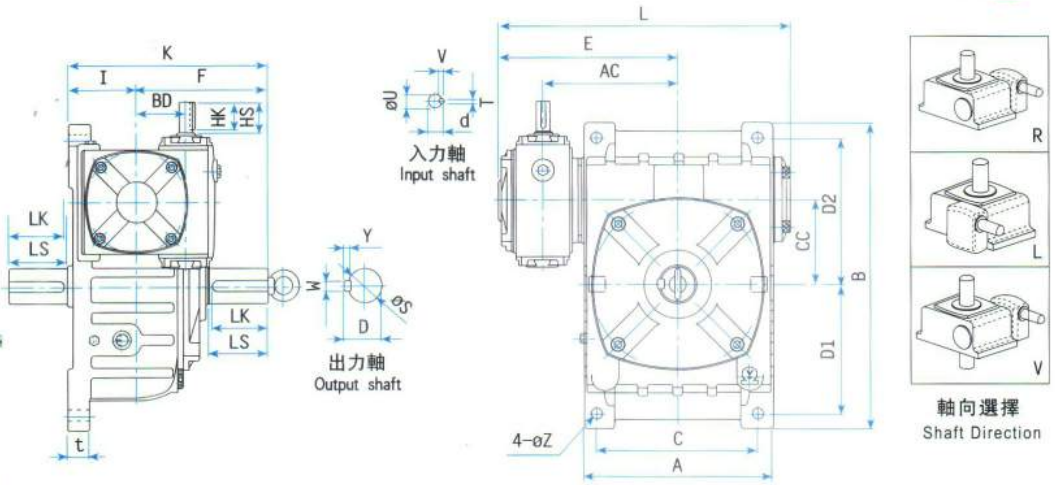

尺寸表 Dimension

單位: m/m

減速比 RATIO	馬力 HP	腳座 FOOT STOCK							外形尺寸 OUTWARD SIZE							入力軸 INPUT SHAFT				出力軸 OUTPUT SHAFT					
		型號 MODEL	1/100- 1/900	1/1000- 1/3600	A	B	C	D1	D2	t	Z	E	F	I	K	L	AC	BD	CC	HS	U	d	TxVxHK	LS	S
60	1/16		130	262	100	105	120	20	11	140	111	55	165	218	100	32	60	25	12	13.5	4x4x25	50	22	25	7x7x45
70	1/8		160	298	120	120	135	22	15	165	130	65	195	260	121	40	70	25	12	14	4x4x25	60	28	31	7x7x55
80	1/4		180	320	140	130	150	23	15	188	145	70	210	295	136	50	80	30	14	16.5	5x5x25	65	32	35.5	10x8x60
100	1/2	1/4	226	380	190	155	180	25	15	214	166	90	260	346	158	60	100	40	15	17	5x5x35	75	38	41.5	10x8x70
120	1	1/2	266	450	220	185	215	30	18	248	195	100	290	407	185	70	120	40	18	20	5x5x35	85	45	48.5	12x8x80
135	2	1	306	495	260	210	235	30	18	292	210	110	324	472	219	80	135	50	22	25	7x7x45	95	55	60	15x10x90
155	3	2	350	460	290	145	265	30	20	348	241	140	393	547	258	100	155	50	25	28	7x7x45	110	60	65	15x10x105
175	5	3	385	520	320	167	293	40	22	393	248	150	412	623	290	120	175	65	30	33	7x7x60	110	65	69	18x10x105

MODEL: TH_D^M

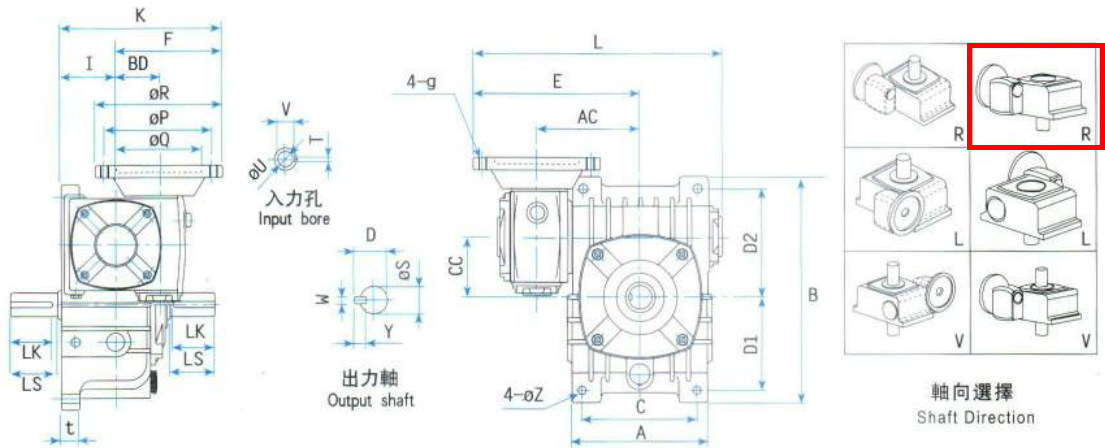

尺寸表 Dimension

單位: m/m

減速比 RATIO	馬力 HP	腳座 FOOT STOCK							外形尺寸 OUTWARD SIZE							馬達盤 IEC MOTOR FLANGE				入力孔 INPUT BORE			出力軸 OUTPUT SHAFT						
		型號 MODEL	1/100- 1/900	1/1000- 1/3600	A	B	C	D1	D2	t	Z	E	F	H	I	K	L	AC	BD	CC	P	Q	R	g	V	T	U	LS	S
80	1/4		180	320	140	130	150	23	15	216	130	310	70	200	323	136	50	80	130	110	160	M8	12.5	4	11	65	32	35.5	10x8x60
100	1/2	1/4	226	380	190	155	180	25	15	238	140	365	90	230	370	158	60	100	130	110	160	M8	12.5	4	11	75	38	41.5	10x8x70
120	1	1/2	266	450	220	185	215	30	18	265	150	432	100	250	424	185	70	120	130	110	160	M8	16	5	14	85	45	48.5	12x8x80
135	2	1	306	495	260	210	235	30	18	319	180	490	110	290	499	219	80	135	165	130	200	M10	21	6	19	95	55	60	15x10x90
155	3	2	350	460	290	145	265	30	20	358	200	470	140	340	557	258	100	155	165	130	200	M10	27	8	24	110	60	65	15x10x105
175	5	3	380	520	320	167	293	40	22	415	245	530	150	395	645	290	120	175	215	180	250	M12	31	8	28	110	65	69	18x10x105

以上尺寸如有變動, 恕不另行通知

We regret that there will be no separate notification, if the above dimensions have been changed.



MODEL:TFAY

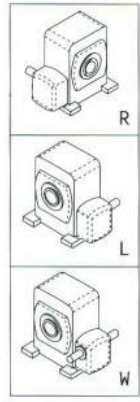
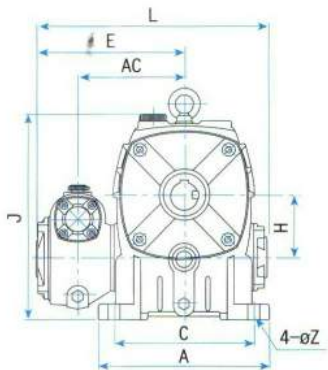
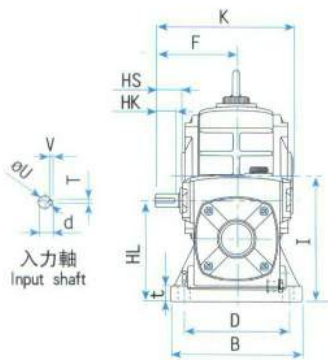

軸向選擇
Shaft Direction

尺寸表 Dimension

單位: m/m

減速比 RATIO	馬力 HP		腳座 FOOT STOCK					外形尺寸 OUTWARD SIZE								輸入軸 INPUT SHAFT				出力孔 OUTPUT BORE					
	型號 MODEL	1/100~ 1/900	1/1000~ 1/3600	A	B	C	D	t	Z	E	F	H	I	J	K	L	AC	HL	HS	U	d	TxVxHK	W	Y	S
60	1/16			150	130	120	105	20	11	144	88	60	120	210	144	222	100	92	25	12	13.5	4x4x25	7	28	25
70	1/8			190	150	150	115	22	15	165	86	70	140	245	151	260	121	111	25	12	13.5	4x4x25	7	33	30
80	1/4			220	170	180	135	23	15	188	105	80	160	280	175	295	136	130	30	14	16.5	5x5x25	10	38	35
100	1/2	1/4		270	190	220	155	25	15	214	120	100	200	345	210	346	158	160	40	15	17	5x5x35	10	43	40
120	1	1/2		320	230	260	180	30	18	248	140	120	240	410	240	407	185	190	40	18	20	5x5x35	12	48	45
135	2	1		350	250	290	200	30	18	290	161	135	270	470	271	471	219	215	50	22	25	7x7x45	15	60	55
155	3	2		390	280	320	220	30	20	348	190	155	290	495	313.5	547	258	235	50	25	28	7x7x45	15	70	65
175	5	3		420	310	350	250	40	22	393	231	175	315	540	362	623	290	280	65	30	33	7x7x60	18	95	90

MODEL:TFAYM

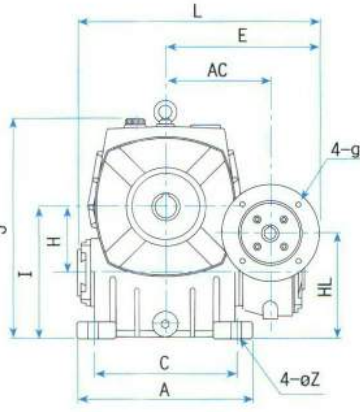
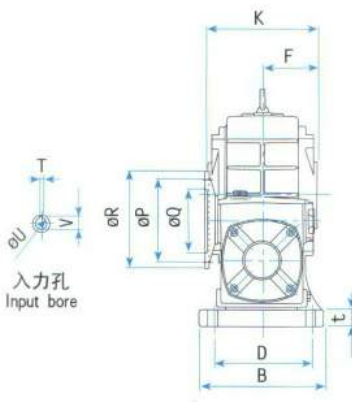

軸向選擇
Shaft Direction

尺寸表 Dimension

單位: m/m

減速比 RATIO	馬力 HP		腳座 FOOT STOCK					外形尺寸 OUTWARD SIZE								馬達盤 IEC MOTOR FLANGE				輸入孔 INPUT BORE			出力孔 OUTPUT BORE					
	型號 MODEL	1/100~ 1/900	1/1000~ 1/3600	A	B	C	D	t	Z	E	F	H	I	J	K	L	AC	HL	P	Q	R	g	V	T	U	W	Y	S
80	1/4			220	170	180	135	23	15	216	75	80	160	280	150	324	136	130	130	110	160	M8	12.5	4	11	10	38	35
100	1/2	1/4		270	190	220	155	25	15	238	91	100	200	345	182	371	158	160	130	110	160	M8	12.5 16	4 5	11 14	10	43	40
120	1	1/2		320	230	260	180	30	18	265 285	107.5	120	240	410	215	424 444	185	190	130 165	110 130	160 200	M8 M10	16 21	5 6	14 19	12	48	45
135	2	1		350	250	290	200	30	18	319	113	135	270	470	226	500	219	215	165	130	200	M10	21 27	6 8	19 24	15	60	55
155	3	2		390	280	320	220	30	20	358 383	123	155	290	495	276	557 582	258	235	165 215	130 180	200 250	M10 M12	27 31	8	24 28	15	70	65
175	5	3		420	310	350	250	40	22	415	137	175	315	540	280	645	290	215	180	250	M12	31	8	28	18	95	90	

以上尺寸如有變動，恕不另行通知
We regret that there will be no separate notification, if the above dimensions have been changed.



DOUBLE REDUCTION WORM REDUCER SERIES 雙段蝸輪減速機系列

MODEL:TFEA

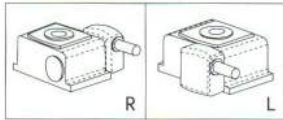

軸向選擇 Shaft Direction

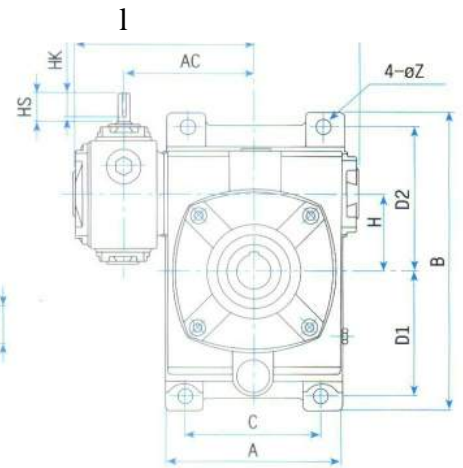
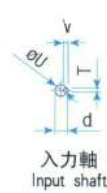
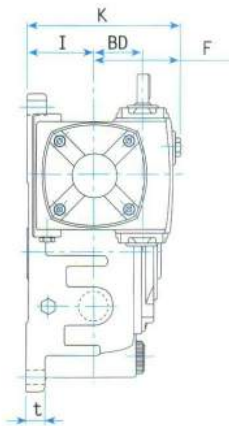

尺寸表 Dimension

單位: m/m

減速比 RATIO		馬力 HP		腳座 FOOT STOCK					外形尺寸 OUTWARD SIZE							輸入軸 INPUT SHAFT				出力孔 OUTPUT BORE				
型號 MODEL	1/100- 1/900	1/1000- 1/3600	A	B	C	D1	D2	t	Z	E	F	H	I	K	L	AC	BD	HS	U	d	TxVxHK	W	Y	S
60	1/16		130	262	100	105	120	20	11	140	65	60	55	120	218	100	32	25	12	13.5	4x4x25	7	28	25
70	1/8		160	298	120	120	135	22	15	165	77	70	65	142	260	121	40	25	12	13.5	4x4x25	7	33	30
80	1/4		180	320	140	130	150	23	15	188	91	80	70	161	295	136	50	30	14	16.5	5x5x25	10	38	35
100	1/2	1/4	226	380	190	155	180	25	15	214	110	100	90	200	346	158	60	40	15	17	5x5x35	10	43	40
120	1	1/2	266	450	220	185	215	30	18	248	125	120	100	225	407	185	70	40	18	20	5x5x35	12	48	45
135	2	1	306	495	260	210	235	30	18	292	138	135	110	248	472	219	80	50	22	25	7x7x45	15	60	55
155	3	2	350	460	290	145	265	30	20	348	170	155	140	310	547	258	100	50	25	28	7x7x45	15	70	65
175	5	3	385	520	320	167	293	40	22	393	193	175	150	343	623	290	120	65	30	33	7x7x60	18	95	90

MODEL:TFEAM

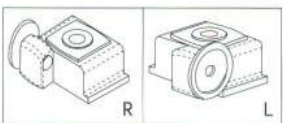

軸向選擇 Shaft Direction

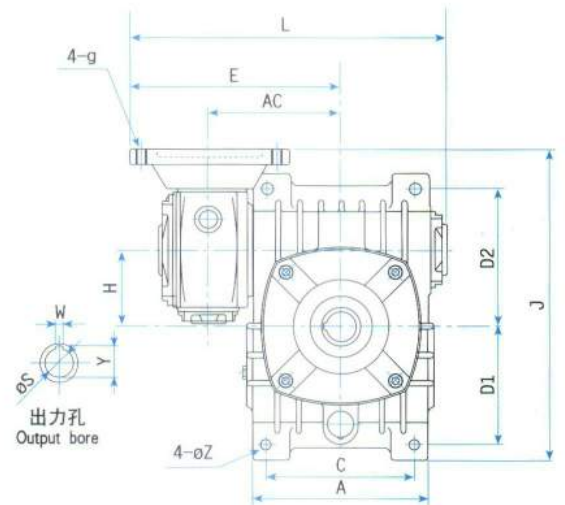
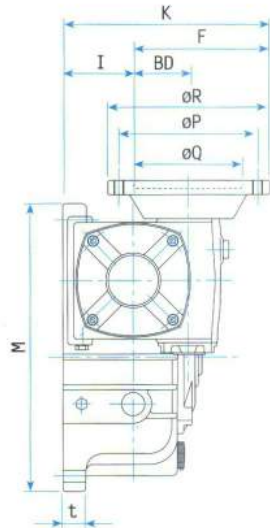

尺寸表 Dimension

單位: m/m

減速比 RATIO		馬力 HP		腳座 FOOT STOCK					外形尺寸 OUTWARD SIZE							馬達盤 IEC MOTOR FLANGE				輸入孔 INPUT BORE			出力孔 OUTPUT BORE					
型號 MODEL	1/100- 1/900	1/1000- 1/3600	A	B	C	D1	D2	t	Z	E	F	H	I	J	K	L	AC	BD	P	Q	R	g	V	T	U	W	Y	S
80	1/4		180	320	140	130	150	23	15	216	130	80	70	310	200	323	136	50	130	110	160	M8	12.5	4	11	10	38	35
100	1/2	1/4	226	380	190	155	180	25	15	238	140	100	90	365	230	370	158	60	130	110	160	M8	12.5 16	4 5	11 14	10	43	40
120	1	1/2	266	450	220	185	215	30	18	265 285	150 170	120	100	432	250 270	424 444	185	70	130 165	110 130	160 200	M8 M10	16 21	5 6	14 19	12	48	45
135	2	1	306	495	260	210	235	30	18	319	180	135	110	490	290	499	219	80	165	130	200	M10	21 27	6 8	19 24	15	60	55
155	3	2	350	460	290	145	265	30	20	358 383	220 225	155	140	470	360 365	557 582	258	100	165 215	130 180	200 250	M10 M12	27 31	8	24 28	15	70	65
175	5	3	385	520	320	167	293	40	22	415	245	175	150	530	395	645	290	120	215	180	250	M12	31	8	28	18	95	90

以上尺寸如有變動，恕不另行通知

We regret that there will be no separate notification, if the above dimensions have been changed.



MODEL:TLD

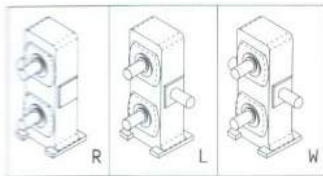
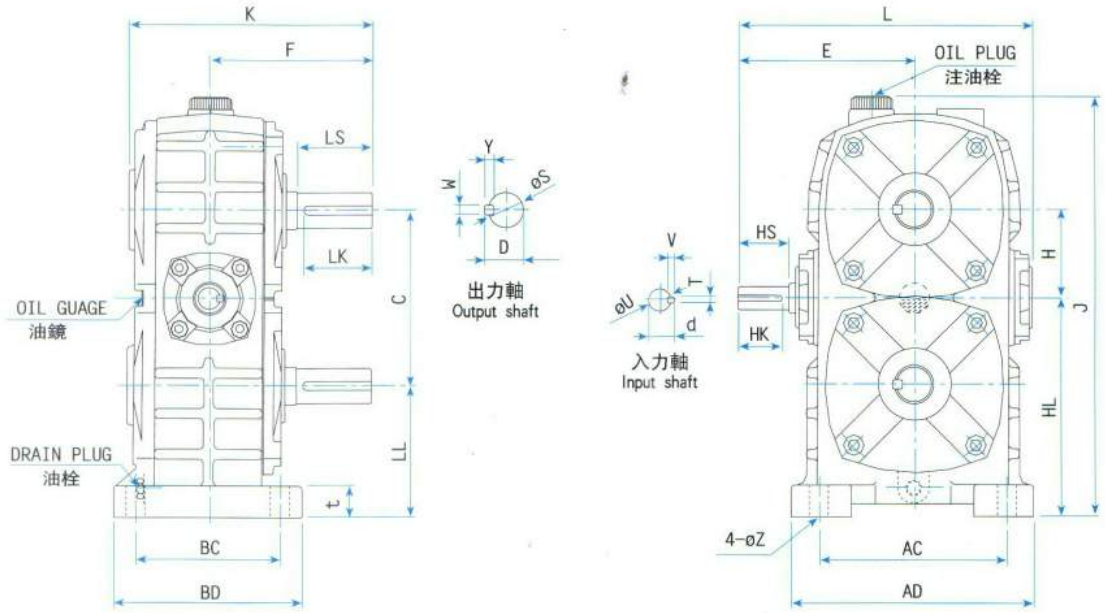

軸向選擇 Shaft Direction

MODEL:TLDM

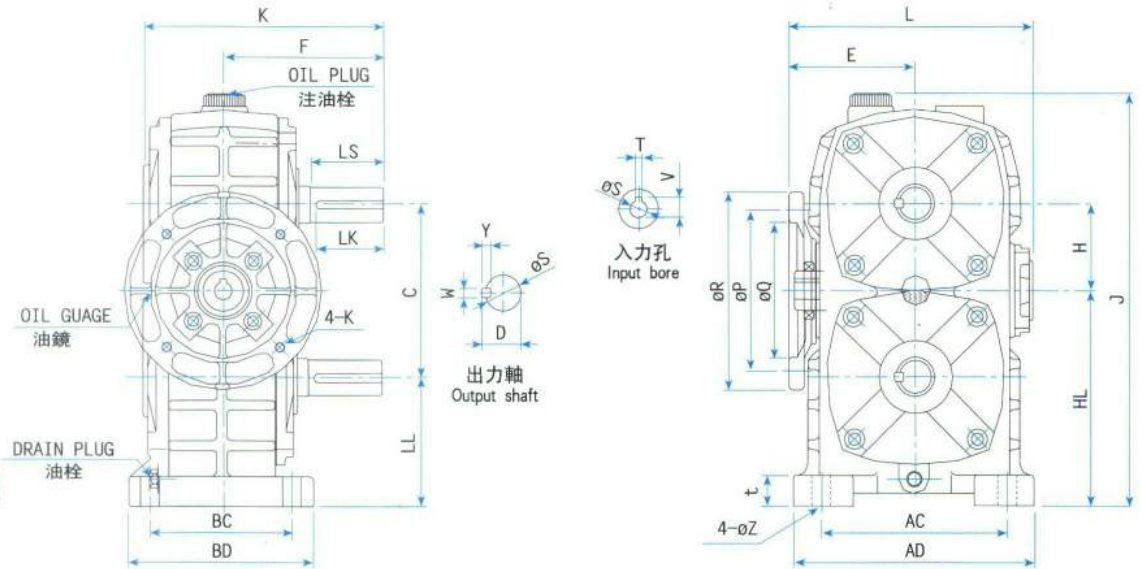

尺寸表 Dimension

單位: m/m

型號 MODEL	減速比 RATIO	外形尺寸 OUTWARD SIZE														入力軸 INPUT SHAFT			出力軸 OUTPUT SHAFT			
		L	E	AC	AD	K	F	BC	BD	C	H	J	HL	LL	CE	Z	HS	U	T x V	LS	S	W x X
55	10-60	217	110	120	155	167	110	105	132	110	55	275	155	100	19	13	30	14	7 x 7	40	17	8 x 7
65		260	130	130	184	173	108	136	162	130	65	300	155	90	25	15	40	15	7 x 7	50	22	8 x 8
70		234	140	150	194	194	129	115	150	140	70	348	175	105	25	15	40	18	7 x 7	60	28	8 x 8
80		268	161	180	220	208	140	135	170	160	80	378	192	112	25	15	50	22	7 x 7	65	32	10 x 8
100		324	190	220	270	258	169	155	197	200	100	472	250	150	27	15	50	25	10 x 8	75	38	10 x 8
120		456	228	260	320	290	186	180	230	240	120	622	300	180	30	18	65	30	10 x 8	85	45	12 x 8
135		516	258	290	350	322	214	200	250	270	135	640	350	215	32	18	75	35	10 x 8	95	55	15 x 10

以上尺寸如有變動，恕不另行通知
 We regret that there will be no Sepcrate notification, if the above dimensions have been changed.



DOUBLE REDUCTION WORM REDUCER(GEAR) 雙段蝸輪減速機(齒輪+蝸輪)系列

MODEL:TFY

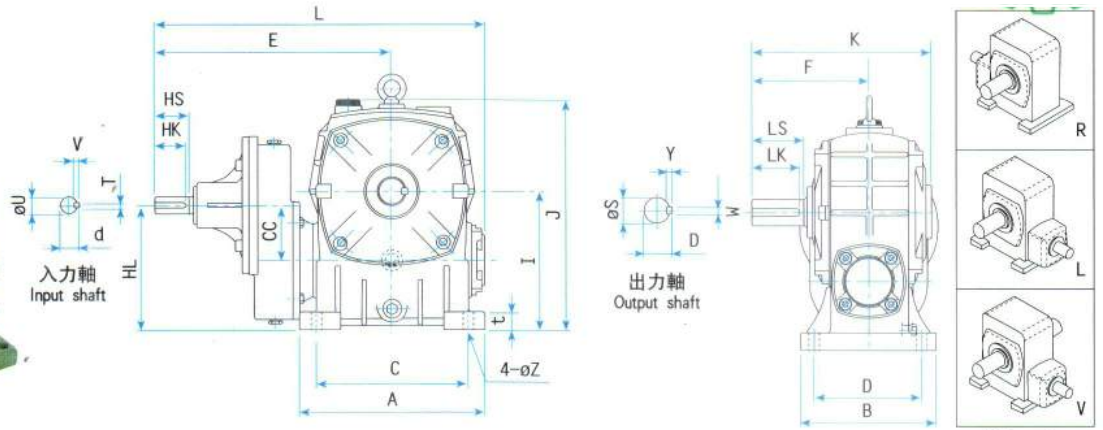

尺寸表 Dimension

型號 MODEL	馬力 HP (4P)	減速比 RATIO	腳座 FOOT STOCK					外形尺寸 OUTWARD SIZE										入力軸 INPUT SHAFT				出力軸 OUTPUT SHAFT			
			A	B	C	D	t	Z	E	F	I	J	K	L	CC	HL	HS	U	d	WxYxHK	LS	S	D	WxYxLK	
80	1/2 1	80-300 80-160	220	170	180	135	23	15	321	145	160	280	217	428	80	160	50	24	27	7x7x45	65	32	35.5	10x8x60	
100	1 2	80-300 80-160	270	195	220	155	25	15	345	166	200	345	262	480	80	180	50	24	27	7x7x45	75	38	41.5	10x8x70	
120	1 2	80-300 80-200	320	230	260	180	30	18	383	195	240	410	292	543	80	200	50	24	27	7x7x45	85	45	48.5	12x8x80	
135	2 3	80-300 80-200	350	250	290	200	30	18	401	210	270	470	322	582	92	227	55	28	31	7x7x50	95	55	60	15x10x90	
155	3 5	80-300 80-160	390	280	320	220	30	20	420	241	290	495	357	620	92	227	55	28	31	7x7x50	110	60	65	15x10x105	

MODEL:TFYM

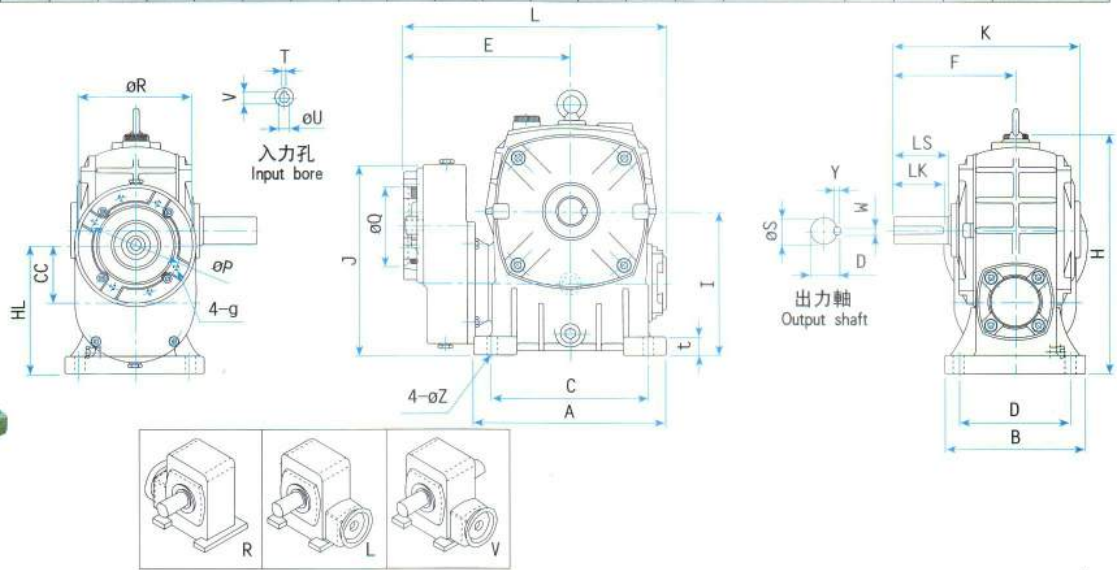

尺寸表 Dimension

型號 MODEL	馬力 HP (4P)	減速比 RATIO	腳座 FOOT STOCK							外形尺寸 OUTWARD SIZE										馬達盤 IEC MOTOR FLANGE				入力孔 INPUT BORE			出力軸 OUTPUT SHAFT			
			A	B	C	D	t	Z	E	F	H	I	J	K	L	CC	HL	P	Q	R	g	V	T	U	LS	S	D	WxYxLK		
80	1/2 1	80-300 80-160	220	170	180	135	23	15	210 216	145	280	160	245	217	317 323	80	160	130 165	110 130	160 200	M8 M10	16 21.5	5 6	14 19	65	32	35.5	10x8x60		
100	1 2	80-300 80-160	270	195	220	155	25	15	241 251	166	345	200	265	262	376 386	80	180	165	130	200	M10	21.5 27	6 8	19 24	75	38	41.5	10x8x70		
120	1 2	80-300 80-200	320	230	260	180	30	18	279 289	195	410	240	300	292	439 449	80	200	165	130	200	M10	21.5 27	6 8	19 24	85	45	48.5	12x8x80		
135	2 3	80-300 80-200	350	250	290	200	30	18	306	210	470	270	353	322	487	92	227	165 215	130 180	200 250	M10 M12	27 31	8 8	24 28	95	55	60	15x10x90		
155	3 5	80-300 80-160	390	280	320	220	30	20	325	241	495	290	353	357	525	92	227	215	180	250	M12	31	8	28	110	60	65	15x10x105		

以上尺寸如有變動、恕不另行通知

We regret that there will be no Sepcirate notification, if the above dimensions have been changed.

DOUBLE REDUCTION WORM REDUCER(GEAR+WORM) SERIES 雙段蝸輪減速機(齒輪+蝸輪)系列



MODEL:THUY

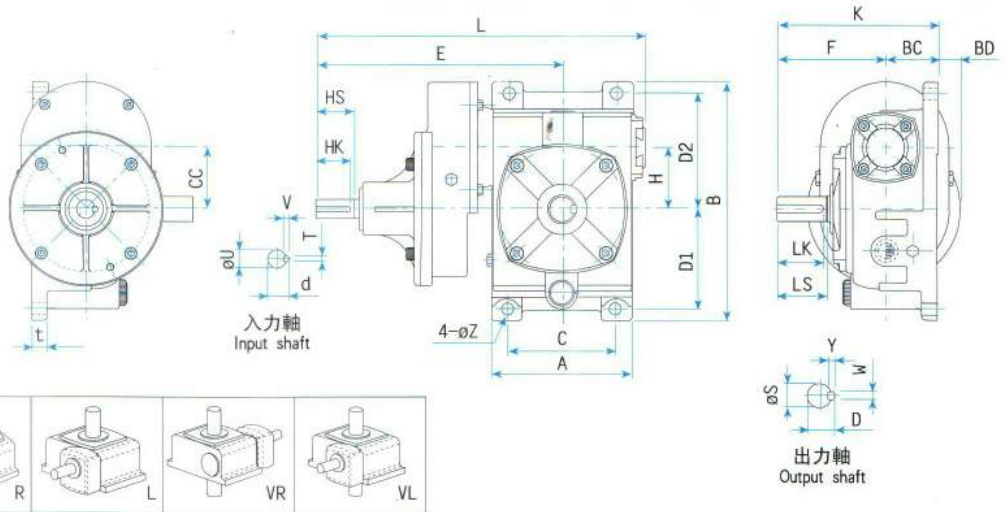

尺寸表 Dimension

軸向選擇 Shaft Direction

型號 MODEL	馬力 HP (4P)	減速比 RATIO	腳座 FOOT STOCK							外形尺寸 OUTWARD SIZE								輸入軸 INPUT SHAFT				輸出軸 OUTPUT SHAFT			
			A	B	C	D1	D2	t	Z	E	F	H	K	L	BC	BD	CC	HS	U	d	TxVxHK	LS	S	D	WxYxLK
80	1/2 1	80-300 80-160	180	320	140	130	150	23	15	321	140	80	210	428	70	15	80	50	24	27	7x7x45	65	32	35.5	10x8x60
100	1 2	80-300 80-160	226	380	190	155	180	25	15	345	170	100	260	480	90	10	80	50	24	27	7x7x45	75	38	41.5	10x8x70
120	1 2	80-300 80-200	266	450	220	185	215	30	18	383	190	120	290	439	100	0	80	50	24	27	7x7x45	85	45	48.5	12x8x80
135	2 3	80-300 80-200	306	495	260	210	235	30	18	401	214	135	324	582	110	16	92	55	28	31	7x7x50	95	55	60	15x10x90
155	3 5	80-300 80-160	350	460	290	145	265	30	20	420	253	155	393	620	140	0	92	55	28	31	7x7x50	110	60	65	15x10x105

MODEL:THUYM

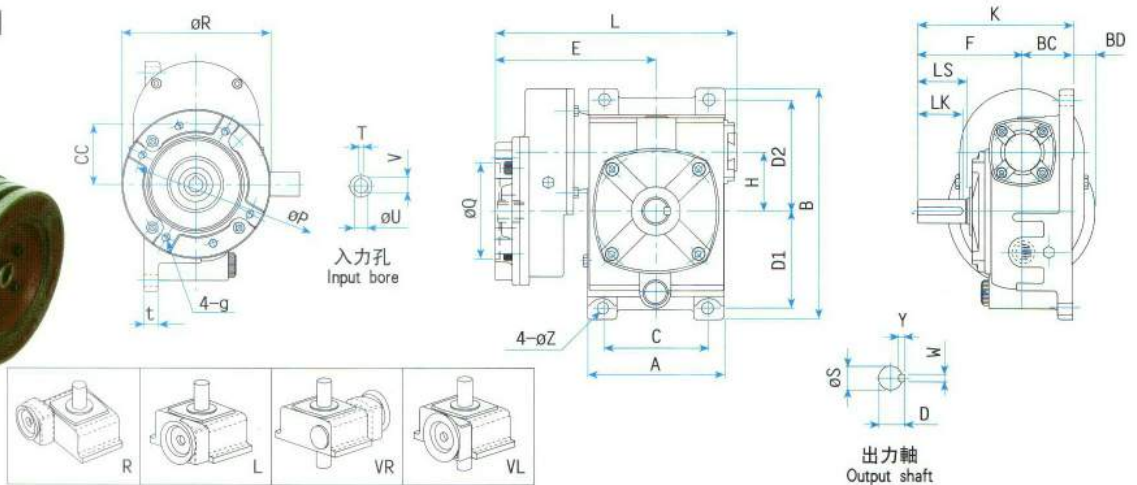

尺寸表 Dimension

軸向選擇 Shaft Direction

單位: m/m

型號 MODEL	馬力 HP (4P)	減速比 RATIO	腳座 FOOT STOCK							外形尺寸 OUTWARD SIZE								馬達盤 IEC MOTOR FLANGE				輸入孔 INPUT BORE				輸出軸 OUTPUT SHAFT			
			A	B	C	D1	D2	t	Z	E	F	H	K	L	BC	BD	CC	P	Q	R	g	V	T	U	LS	S	D	WxYxLK	
80	1/2 1	80-300 80-160	180	320	140	130	150	23	15	210 216	140	80	210	317 323	70	15	80	130 165	110 130	160 200	M8 M10	16 21.5	5 6	14 19	65	32	35.5	10x8x60	
100	1 2	80-300 80-160	226	380	190	155	180	25	15	241 251	170	100	260	376 386	90	10	80	165	130	200	M10	21.5 27	6 8	19 24	75	38	41.5	10x8x70	
120	1 2	80-300 80-200	266	450	220	185	215	30	18	279 289	190	120	290	439 449	100	0	80	165	130	200	M10	21.5 27	6 8	19 24	85	45	48.5	12x8x80	
135	2 3	80-300 80-200	306	495	260	210	235	30	18	306	214	135	324	487	110	15 16	92	165 215	130 180	200 250	M10 M12	27 31	8 8	24 28	95	55	60	15x10x90	
155	3 5	80-300 80-160	350	460	290	145	265	30	20	325	253	155	392	525	140	0	92	215	180	250	M12	31	8	28	110	60	65	15x10x105	

以上尺寸如有變動, 恕不另行通知

We regret that there will be no separate notification, if the above dimensions have been changed.



SINGLE REDUCTION WORM REDUCER SERIES 單段蝸輪減速機系列

MODEL: TNY

(裝配油壓馬達用) For assembling hydraulic motor

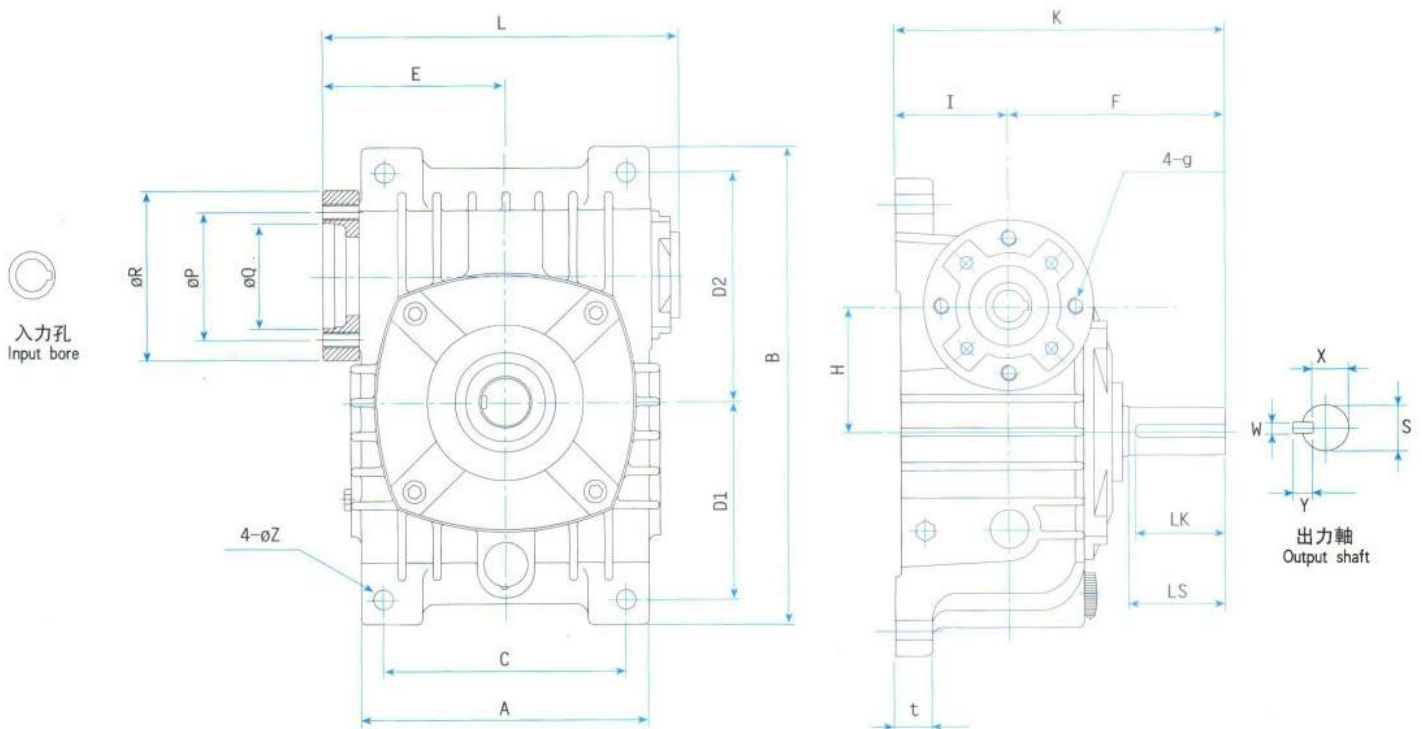

尺寸表 Dimension

單位: m/m

減速比 RATIO	馬力 HP	腳座 FOOT STOCK							外形尺寸 OUTWARD SIZE					油壓盤 MOTORFLANGE				入力孔 INPUT BORE			出力軸 OUTPUT SHAFT			
		A	B	C	D1	D2	t	Z	E	F	H	I	L	P	Q	R	G	V	T	U	LS	S	X	WxXxLK
100	1/10~1/30	226	380	190	155	180	25	15	143.5	166	100	90	278	107	82.55	133	M12	28.575	6.35	25.4	75	38	33.5	10x8x70
120	1/40~1/60	266	450	220	185	215	30	18	155	195	120	100	314	107	82.55	145	M12	28.575	6.35	25.4	85	45	40.5	12x8x80
135		306	495	260	210	235	30	18	178	159	135	110	358	107	82.55	153	M12	28.575	6.35	25.4	45	55	50	15x10x40
155		345	465	290	145	265	30	20	197	193	155	140	396	107	82.55	153	M12	28.575	6.35	25.4	50	60	55	15x10x45
175		385	520	320	167	293	40	22	227.5	210	175	150	457	107	82.55	174	M12	28.575	6.35	25.4	55	65	59	18x10x50

We regret that there will be no separate notification, if the above dimensions have been changed.



MODEL:EB-M

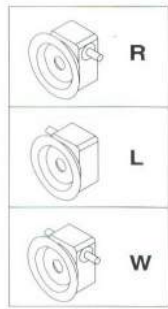

轉向選擇
 Shaft Direction

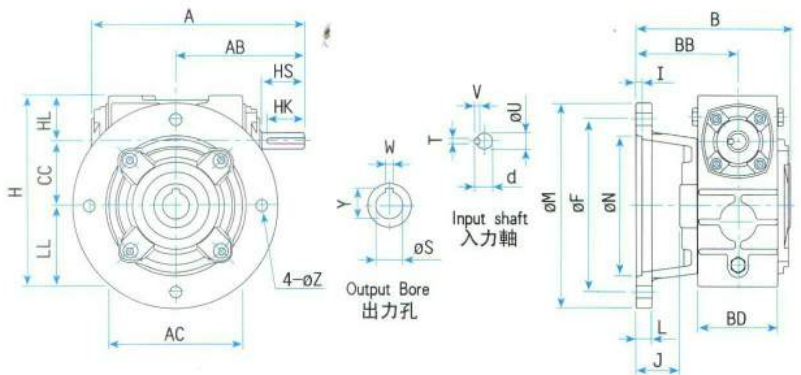

尺寸表 Dimension

單位: m/m

減速比 RATIO	馬力 HP		A	AB	AC	B	BB	BD	CC	HL	LL	H	M	F	L	I	J	N	Z	入力軸 INPUT SHAFT				出力孔 OUTPUT BORE		
	型號 MODEL	1/10- 1/30																		1/40- 1/60	HS	U	d	TxVxHK	W	Y
50	1/4		178	105	115	146	96	70	50	35	65	150	180	150	13	6	46	130	11	30	12	13.5	4x4x25	5	22.8	20
60	1/2	1/4	198	120	125	151	96	77	60	42	75	177	190	160	15	6	41	130	11	40	15	17	5x5x35	7	28	25
70	1	1/2	235	140	158	180	115	87	70	50	85	205	250	215	15	6	50	180	15	40	18	20	5x5x35	7	33	30
80	2	1	268	161	175	185	115	98	80	60	92	232	250	215	16	6	45	180	15	50	22	25	7x7x45	10	38	35
100	3	2	322	190	226	235	145	117	100	75	115	290	300	265	16	5	55	230	15	50	25	28	7x7x45	10	43	40
120	5	3	390	231	264	245	145	137	120	95	155	370	350	300	20	7	45	260	17	65	30	33	7x7x60	12	48	45
135	7 1/2	5	438	258	306	280	175	150	135	105	185	425	400	350	24	7	65	320	19	75	35	38	10x8x70	15	60	55

MODEL:EM-M



轉向選擇
 Shaft Direction

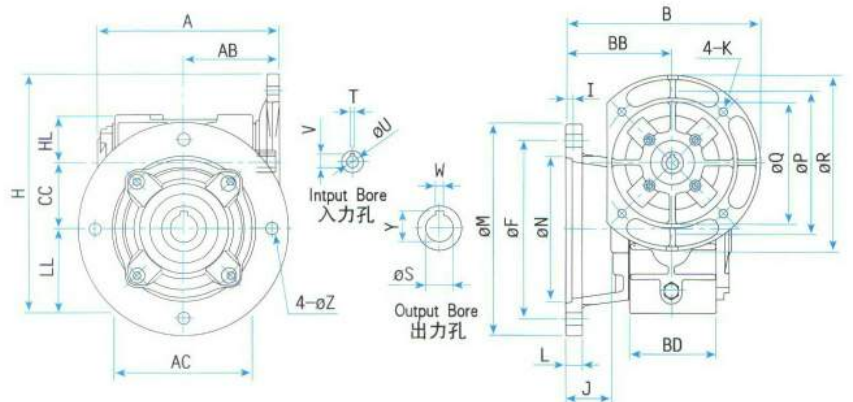

尺寸表 Dimension

單位: m/m

減速比 RATIO	馬力 HP		A	AB	AC	B	BB	BD	CC	HL	LL	H	M	F	L	I	J	N	Z	馬達盤 MOTOR FLANGE				入力孔 INPUT BORE			出力孔 OUTPUT BORE		
	型號 MODEL	1/10- 1/30																		1/40- 1/60	P	Q	R	K	V	T	U	W	Y
50	1/4		154	81	115	176	96	70	50	35	65	195	180	150	13	6	46	130	11	130	110	160	M8	12.7	4	11	5	22.8	20
60	1/2	1/4	167	86	125	176	96	77	60	42	75	215	190	160	15	6	41	130	11	130	110	160	M8	12.7 16.3	4 5	11 14	7	28	25
70	1	1/2	200	102	158	195 215	115	87	70	50	85	235 255	250	215	15	6	50	180	15	130 165	110 130	160 200	M8 M10	16.3 21.8	5 6	14 19	7	33	30
80	2	1	223	116	175	215	115	98	80	60	92	272	250	215	16	6	45	180	15	165	130	200	M10	21.8 27.3	6 8	19 24	10	38	35
100	3	2	278	144	226	245 270	145	117	100	75	115	315 340	300	265	16	5	55	230	15	165 215	130 180	200 250	M10 M12	27.3 31.3	8	24 28	10	43	40
120	5	3	323	164	264	270	145	137	120	95	155	400	350	300	20	7	45	260	17	215	180	250	M12	31.3	8	28	12	48	45
135	7 1/2	5	369	187	306	300 325	175	150	135	105	185	445 470	400	350	24	7	65	320	19	215 265	180 230	250 300	M12	31.3 41.3	8 10	28 38	15	60	55

以上尺寸如有變動，恕不另行通知
 We regret that there will be no separate notification, if the above dimensions have been changed.



SINGLE REDUCTION WORM REDUCER SERIES 單段蝸輪減速機系列

MODEL:EU

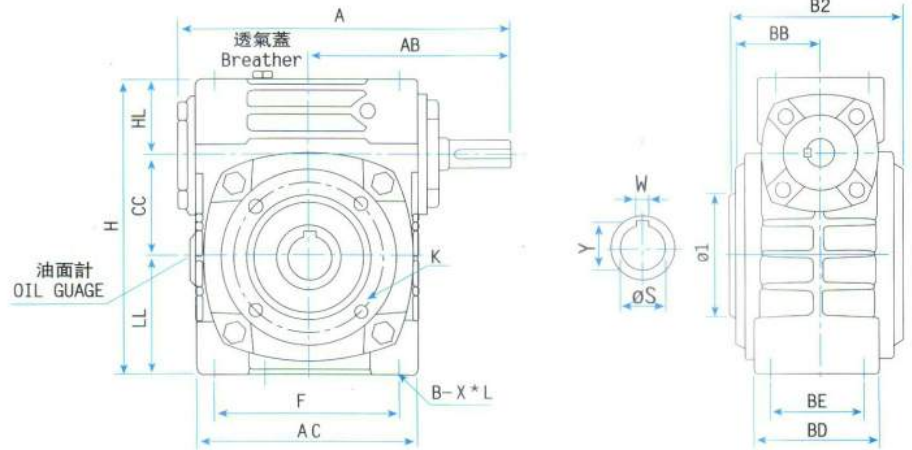

MODEL:EMU

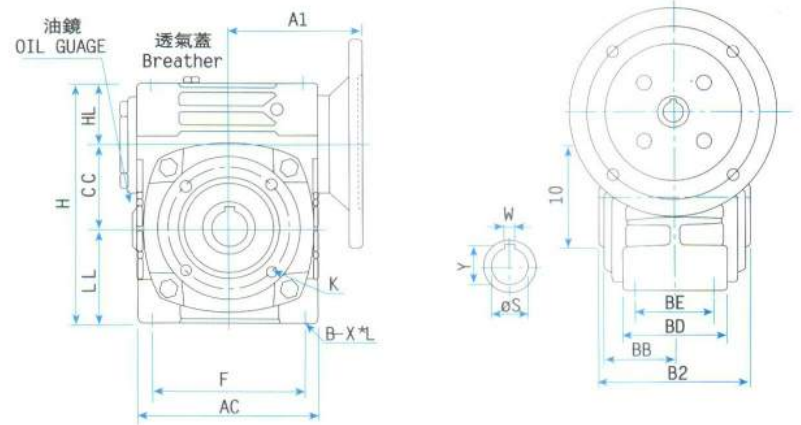

型號 MODEL	出力孔 OUTPUT BORE		
	S	W	Y
50	20	5	22
60	25	7	28
70	30	7	33
80	35	10	38
100	40	10	43
120	45	12	48
135	55	15	60
155	65	15	70

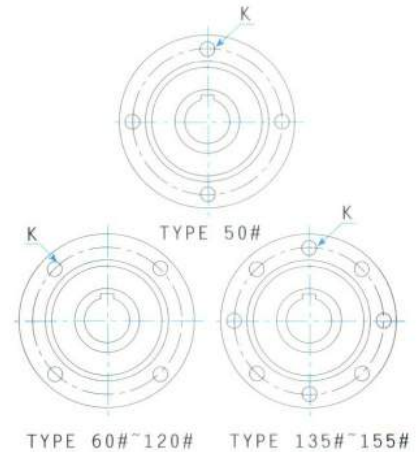

尺寸表 Dimension

單位: m/m

型號 MODEL	減速比 RATIO	A	A1	AB	AC	F	B2	BB	BD	BE	CC	H	HL	LL	X×L	K
50	1/10	175	81	105	115	90	99	47	70	50	50	150	35	65	M8×16	76×4-M6
60	1/15	198	86	120	125	100	112	53	77	55	60	177	42	75	M10×20	82×4-M8
70	1/20	235	102	140	158	125	131	62	87	65	70	205	50	85	M10×20	100×4-M10
80	1/30	264	116	161	175	145	144	68	98	75	80	232	60	92	M10×20	115×4-M10
100	1/40	325	144	190	226	185	175	8.3	117	85	100	290	75	115	M12×24	130×4-M12
120	1/50	389	164	231	264	220	200	95	137	100	120	370	95	155	M14×28	165×4-M12
135	1/60	438	187	258	306	260	216	102	150	110	135	425	105	185	M16×30	200×8-M12
155		510	232	320	340	280	270	115	160	120	155	423	103	165	M16×35	215×8-M12

H TYPE BASE KITS

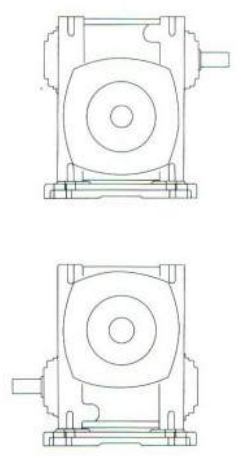
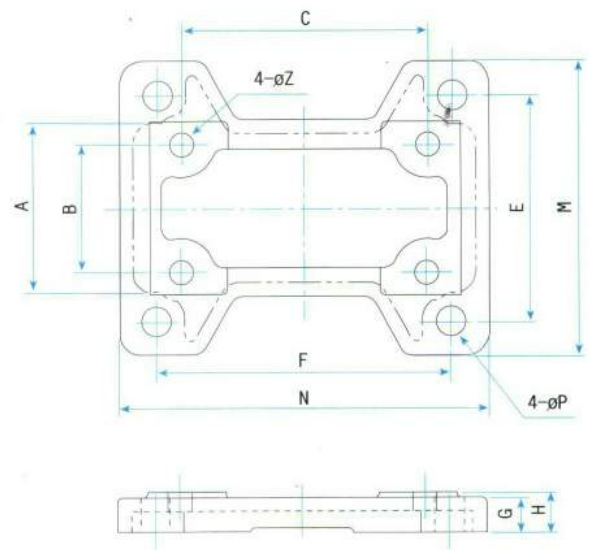

尺寸表 Dimension

單位: m/m

型號 MODEL	A	B	C	E	F	G	H	M	N	P	Z
40	55	35	76	71	80	12	12	97	104	14x9	7
50	70	50	90	95	110	13	15	120	140	11	9
60	80	55	100	105	120	15	18	130	150	11	11
70	88	65	125	115	150	17	20	150	188	15	12
80	100	75	145	135	180	17	20	168	218	15	12
100	118	85	185	155	220	21	25	188	268	15	12
120	132	100	220	180	260	21	25	230	320	18	15
135	145	110	260	200	290	25	30	250	350	18	17

L 型腳座

L TYPE BASE KITS

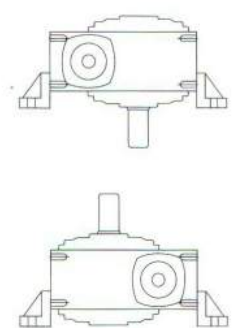
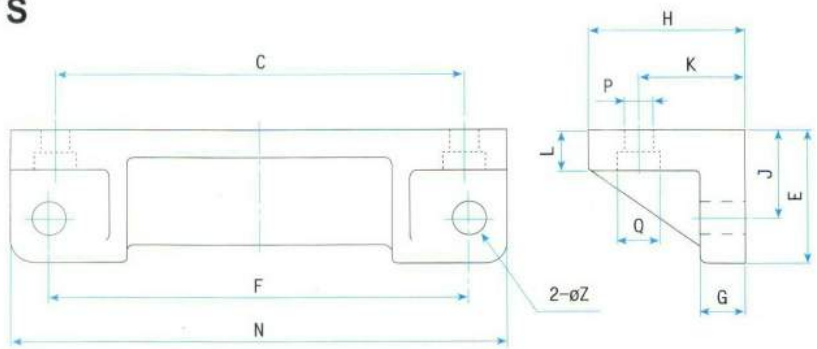

尺寸表 Dimension

單位: m/m

型號 MODEL	C	E	F	G	H	J	K	L	N	P	Z
50	90	40	90	14	40	25	25	9	115	9	11
60	100	45	100	15	45	30	27.5	12	126	11	11
70	125	50	120	18	50	35	32.5	14	155	11	15
80	145	60	140	20	52	40	32.5	18	174	11	15
100	185	60	190	20	70	40	47.5	18	224	13	15
120	220	62.5	220	24	80	40	50	18	264	15	18
135	260	67.5	260	28	77	45	55	24	304	17	18

以上尺寸如有變動，恕不另行通知
We regret that there will be no Sepcirate notification, if the above dimensions have been changed.



WORM REDUCER SERIES 蝸輪減速機系列

MODEL:EB

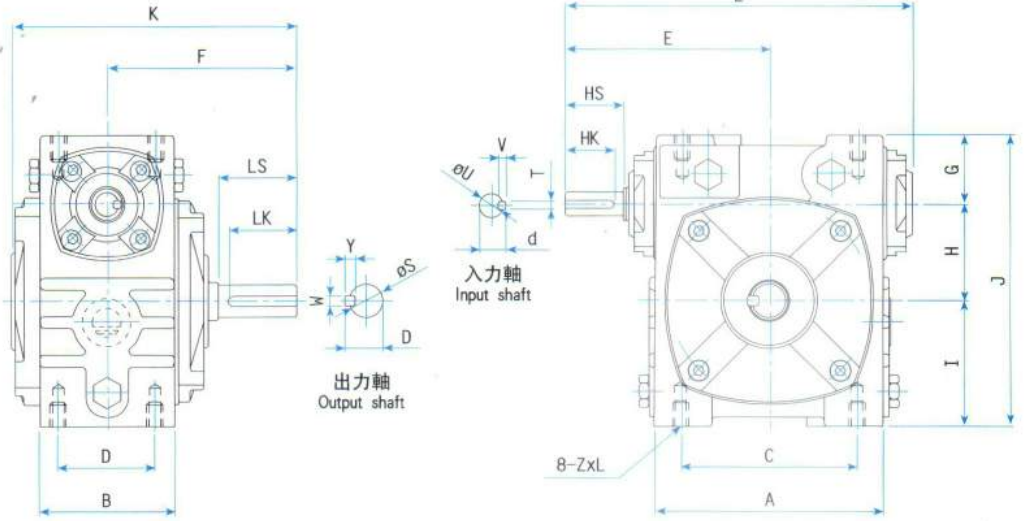

MODEL:EY

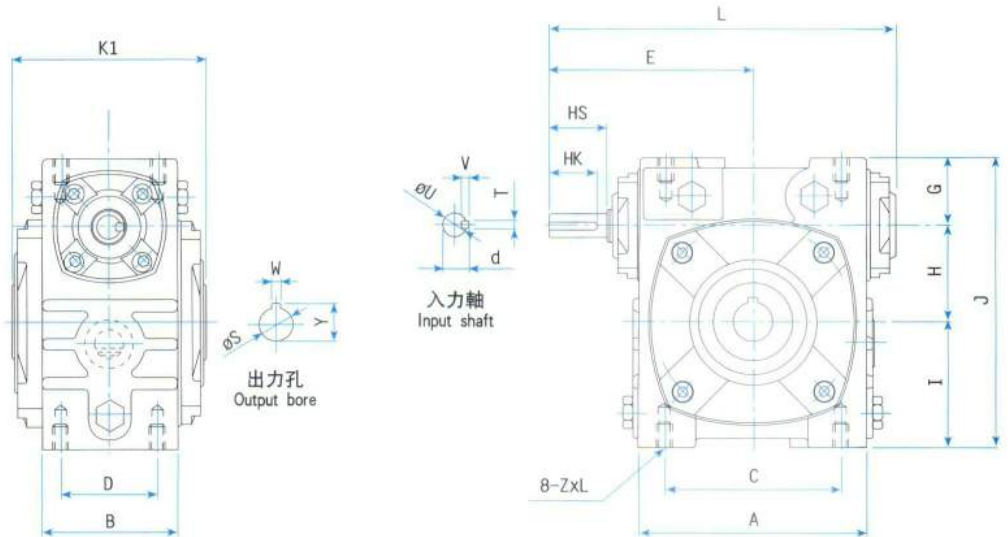

型號 MODEL	出力孔 OUTPUT BORE		
	W	S	Y
40	5	20	22
50	5	20	22
60	7	25	28.3
70	7	30	33
80	10	35	38
100	10	40	43
120	12	45	48
135	15	55	60
155	15	65	70

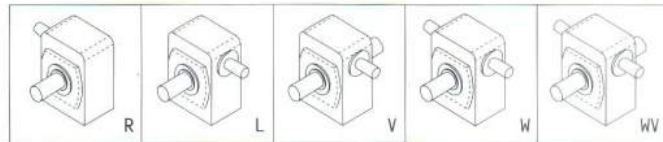

軸向選擇 Shaft Direction

尺寸表 Dimension

單位: m/m

減速比 RATIO	馬力 HP	腳座 FOOT STOCK					外形尺寸 OUTWARD SIZE							輸入軸 INPUT SHAFT				輸出軸 OUTPUT SHAFT					
		A	B	C	D	ZxL	E	F	G	H	I	J	K	K1	L	HS	U	d	TxVxHK	LS	S	D	WxYxLK
40	1/8	92	55	76	35	M6x20	86	80	28	40	48	116	122	90	139.5	25	12	13.5	4x4x20	30	15	17	5x5x25
50	1/4	115	70	90	50	M8x16	105	98	35	50	65	150	149	100	178	30	12	13.5	4x4x25	40	17	19	5x5x35
60	1/2	125	77	100	55	M10x20	120	110	42	60	75	177	164	110	198	40	15	17	5x5x35	50	22	25	7x7x45
70	1	158	87	125	65	M10x20	140	130	50	70	85	205	193	130	235	40	18	20	5x5x35	60	28	31	7x7x55
80	2	175	98	145	75	M10x20	161	140	60	80	92	232	210	140	268	50	22	25	7x7x45	65	32	35	10x8x60
100	3	226	117	185	85	M12x24	190	170	75	100	115	290	260	180	322	50	25	28	7x7x45	75	38	41	10x8x70
120	5	264	137	220	100	M14x28	231	190	95	120	155	370	288	200	390	65	30	33	7x7x60	85	45	48	12x8x80
135	7 1/2	306	150	260	110	M16x30	258	214	105	135	185	425	322	220	438	75	35	38	10x8x70	95	55	59	15x10x90
155	10	340	160	280	120	M16x35	320	252	103	155	165	423	386	276	510	85	40	43	10x8x80	110	60	65	15x10x105

以上尺寸如有變動，恕不另行通知

We regret that there will be no separate notification, if the above dimensions have been changed.



MODEL: EMB

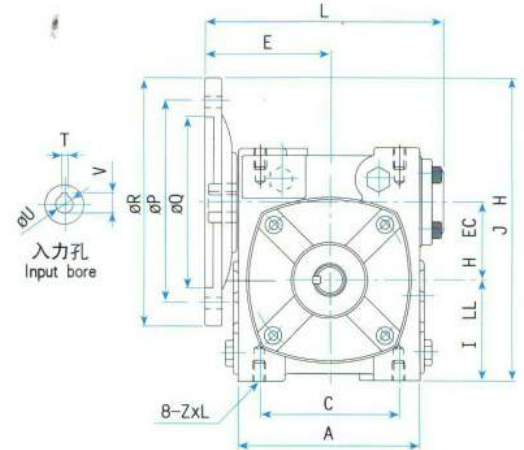
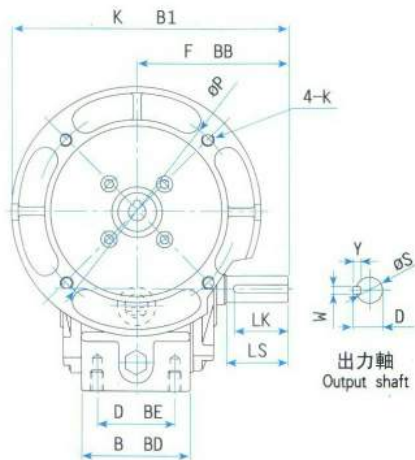

MODEL: EMY

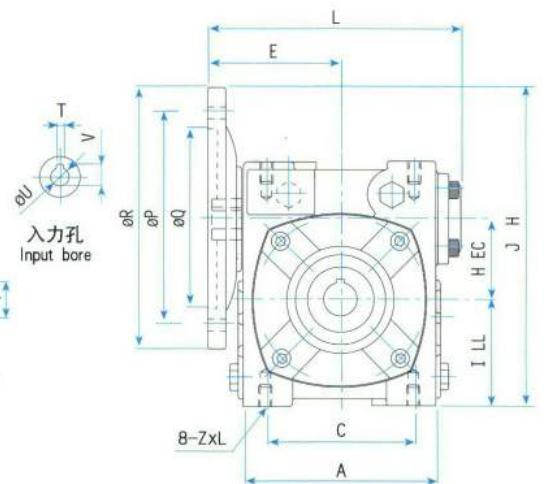
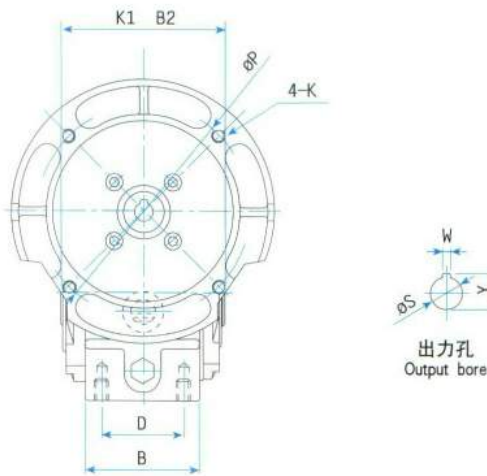

型號 MODEL	出力孔 OUTPUT BORE		
	S	W	Y
50	20	5	22
60	25	7	28
70	30	7	33
80	35	10	38
100	40	10	43
120	45	12	48
135	55	15	60
155	65	15	70

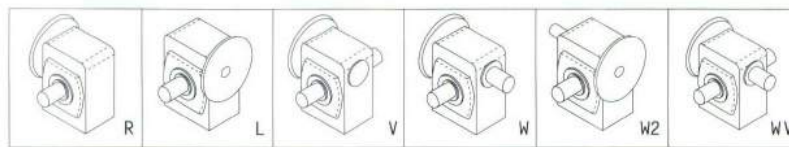

軸向選擇 Shaft Direction

尺寸表 Dimension

單位: m/m

減速比 RATIO	馬力 HP	腳座 FOOT STOCK					外形尺寸 OUTWARD SIZE							馬達盤 IEC及入力孔 MOTOR FLANGE & INPUT BORE							出力軸 OUTPUT SHAFT				
		A	B	C	D	ZxL	E	F	H	I	J	K	K1	L	P	Q	R	g	V	T	U	LS	S	D	WxYxLK
50	1/4	115	70	90	50	M8x16	81	98	50	65	195	178	100	154	130	110	160	M8	12.7	4	11	40	17	19	5x5x35
60	1/2	125	77	100	55	M10x20	86	110	60	75	215	190	110	167	130	110	160	M8	12.7 16.3	4 5	11 14	50	22	25	7x7x45
70	1	158	87	125	65	M10x20	102	130	70	85	235 255	210 230	130	200	130 165	110 130	160 200	M8 M10	16.3 21.8	5 6	14 19	60	28	31	7x7x55
80	2	175	98	145	75	M10x20	116	140	80	92	272	240	140	223	165	130	200	M10	21.8 27.3	6 8	19 24	65	32	35	10x8x60
100	3	226	117	185	85	M12x24	144	170	100	115	315 340	270 295	180	278	165 215	130 180	200 250	M10 M12	27.3 31.3	8	24 28	75	38	41	10x8x70
120	5	264	137	220	100	M14x28	164	190	120	155	400	315	200	323	215	180	250	M12	31.3	8	28	85	45	48	12x8x80
135	7 1/2	306	150	260	110	M16x30	187	258	135	185	425	339 364	220	369	215 265	180 230	250 300	M12	31.3 41.3	8	28 38	95	55	59	15x10x90
155	10	340	160	280	120	M16x38	232	252	155	165	470	402	276	437	265	230	300	M12	41.3	10	38	110	60	65	15x10x105

以上尺寸如有變動，恕不另行通知
 We regret that there will be no separate notification, if the above dimensions have been changed.



DOUBLE REDUCTION WORM REDUCER SERIES 雙段蝸輪減速機系列

MODEL:EBF

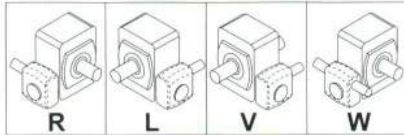

軸向選擇 Shaft Direction

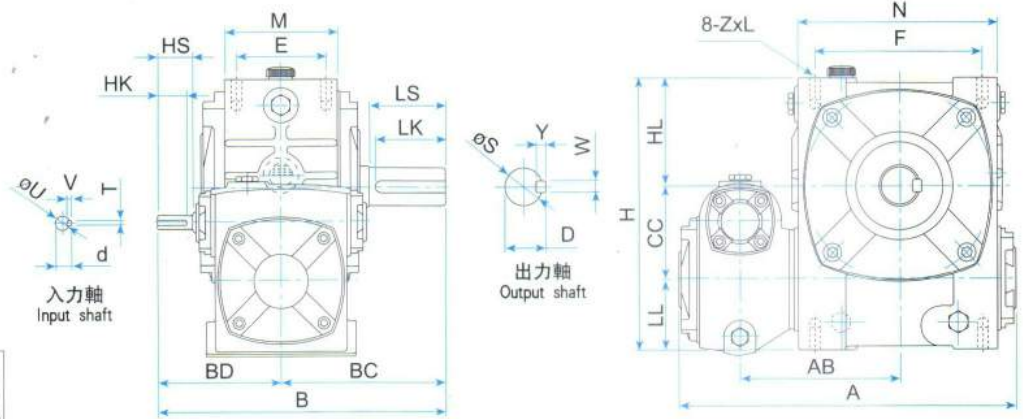

尺寸表 Dimension

單位: m/m

減速比 RATIO	馬力 HP	A	AB	B	BC	BD	CC	LL	HL	H	腳座 FOOT STOCK				輸入軸 INPUT SHAFT				輸出軸 OUTPUT SHAFT				
											E	F	M	N	ZxL	HS	U	d	TxVxHK	LS	S	D	WxYxLK
60	1/16	218	100	198	110	88	60	42	75	177	55	100	77	125	M10x20	25	12	13.5	4x4x25	50	22	25	7x7x45
70	1/8	260	121	216	130	86	70	50	85	205	65	125	87	158	M10x20	25	12	13.5	4x4x20	60	28	31	7x7x55
80	1/4	295	136	245	140	105	80	60	92	232	75	145	98	175	M10x20	30	12	13.5	4x4x25	65	32	35	10x8x60
100	1/2	346	158	290	170	120	100	75	115	290	85	185	117	226	M12x24	40	15	17	5x5x35	75	38	41	10x8x70
120	1	407	185	330	190	140	120	95	155	370	100	220	137	264	M14x28	40	18	20	5x5x35	85	45	48	12x8x80
135	2	471	219	375	214	161	135	105	185	425	110	260	150	306	M16x35	50	22	25	7x7x45	95	55	59	15x10x90

MODEL:EMBF

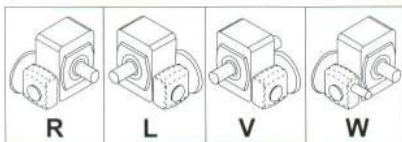

軸向選擇 Shaft Direction

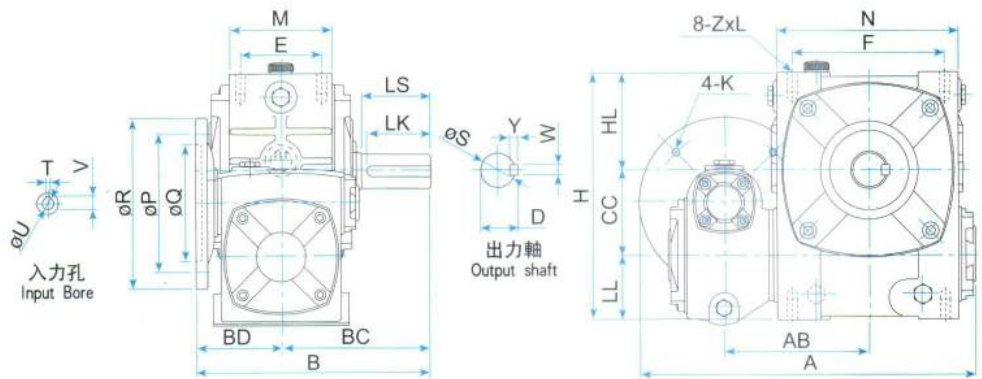

尺寸表 Dimension

單位: m/m

減速比 RATIO	馬力 HP	A	AB	B	BC	BD	CC	LL	HL	H	馬達盤IEC MOTOR FLANGE				腳座 FOOT STOCK				輸入孔 INPUT BORE			輸出軸 OUTPUT SHAFT				
											P	Q	R	K	E	F	M	N	ZxL	V	T	U	LS	S	D	WxYxLK
80	1/4	323	136	221	140	81	80	60	92	232	130	110	160	M8	75	145	98	175	M10x20	12.7	4	11	65	32	35	10x8x60
100	1/2	370	158	256	170	86	100	75	115	290	130	110	160	M8	85	185	117	226	M12x24	12.7	4	11	75	38	41	10x8x70
120	1	424 444	185	291	190	101	120	95	155	370	130 165	110 130	160 200	M8 M10	100	220	137	264	M14x28	16.3 21.8	5 6	14 19	85	45	48	12x8x80
135	2	499	219	330	214	116	135	105	185	425	165	130	200	M10	110	260	150	306	M16x35	21.8 27.3	6 8	19 24	95	55	59	15x10x90

以上尺寸如有變動, 恕不另行通知

We regret that there will be no separate notification, if the above dimensions have been changed.



FLANGE-MOUNTED WORM REDUCER SERIES 法蘭式蝸輪減速機

MODEL: TB-MB



★ 50#~120#

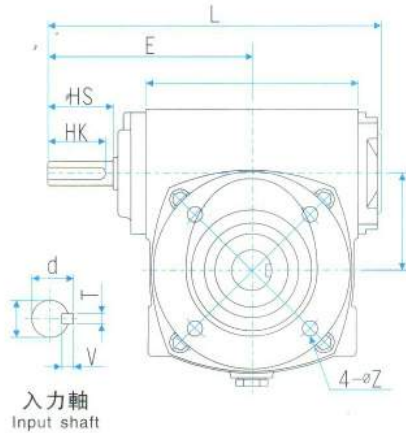

入力軸
Input shaft

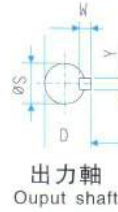

出力軸
Output shaft

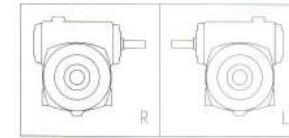

軸向選擇 Shaft Direction

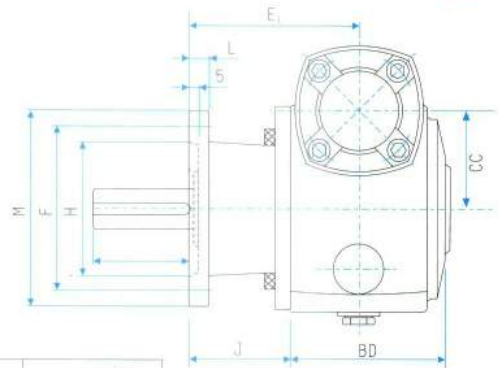

尺寸表 Dimension

單位: m/m

減速比 RATIO	馬力 HP		外形尺寸 OUTWARD SIZE											入力軸 INPUT SHAFT				出力軸 OUTPUT SHAFT					
	型號 MODEL	1/10~ 1/30	1/40~ 1/60	L	E	E1	BD	CC	H	M	F	L	I	J	Z	HS	U	d	T x V x HK	W	D	Y	S
50	1/4			175	105	96	70	50	80	120	100	13	58	46	11	30	12	13.5	4 x 4 x 25	21	28	7	25
60	1/2	1/4		195	120	96	77	60	80	120	100	15	68	41	11	40	15	17	5 x 5 x 35	24	31	7	28
70	1	1/2		235	140	115	87	70	120	182	150	15	75	55	15	40	18	20	5 x 5 x 35	27.5	36	10	32
80	2	1		265	161	115	98	80	130	185	160	16	85	70	15	50	22	25	7 x 7 x 45	33.5	42	10	38
100	3	2		323	190	145	117	100	180	235	210	16	90	85	15	50	25	28	7 x 7 x 45	40.5	49	12	45
120	5	3		385	231	145	137	120	280	330	300	20	95	85	17	65	30	33	7 x 7 x 60	50	60	15	55

MODEL: TM-MB



★ 50#~120#

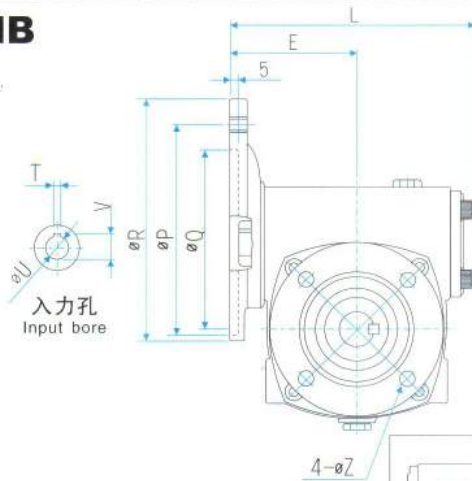

入力孔
Input bore



出力軸
Output shaft

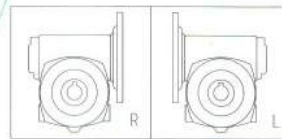

軸向選擇 Shaft Direction

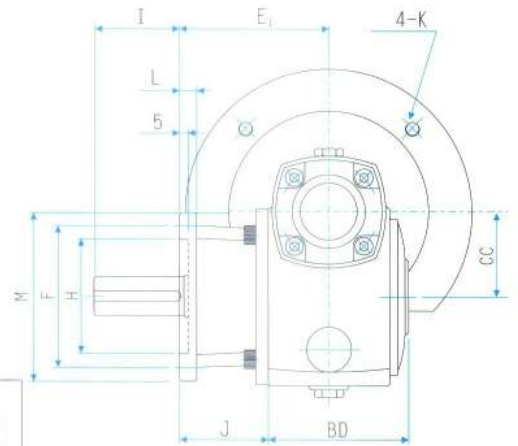

尺寸表 Dimension

單位: m/m

減速比 RATIO	馬力 HP		外形尺寸 OUTWARD SIZE													馬達盤 ICE MOTOR FLANGE				入力孔 INPUT BORE				出力軸 OUTPUT SHAFT			
	型號 MODEL	1/10~ 1/30	1/40~ 1/60	L	E	E1	BD	CC	H	M	F	L	I	J	Z	P	Q	R	g	V	T	U	W	D	Y	S	
50	1/4			154	81	96	70	50	80	120	100	13	58	46	11	130	110	160	M8	12.7	4	11	21	28	7	25	
60	1/2	1/4		167	86	96	77	60	80	120	100	15	68	41	11	130	110	160	M8	12.7	4	11	24	31	7	28	
70	1	1/2		200	102	115	87	70	120	182	150	15	75	55	15	130	110	160	M8	16.3	5	14	27.5	36	10	32	
80	2	1		223	116	115	98	80	130	185	160	16	85	70	15	165	130	200	M10	21.8	6	19	33.5	42	10	38	
100	3	2		278	144	145	117	100	180	235	210	16	90	85	55	165	130	200	M10	27.3	8	24	40.5	49	12	45	
120	5	3		323	164	145	137	120	280	330	300	20	95	85	17	215	180	250	M12	31.3	8	28	50	60	15	55	

以上尺寸如有變動, 恕不另行通知

We regret that there will be no separate notification, if the above dimensions have been changed.

MODEL: TB-M



★ 50#~120#

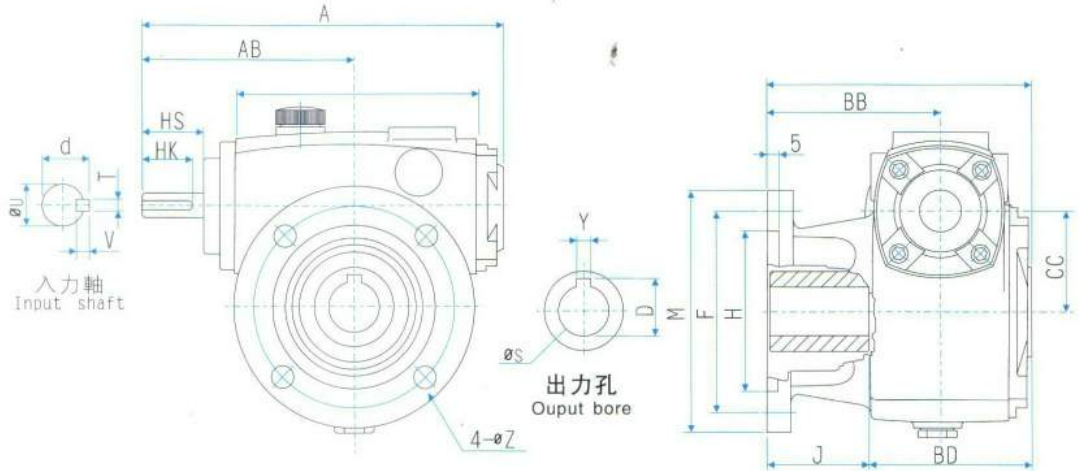

尺寸表 Dimension

單位: m/m

減速比 RATIO	馬力 HP		外形尺寸 OUTWARD SIZE											輸入軸 INPUT SHAFT				出力孔 OUTPUT BORE			
	型號 MODEL	1/10~ 1/30	1/40~ 1/60	A	AB	BB	BD	CC	H	M	F	L	J	Z	HS	U	d	T x V x HK	D	Y	S
50	1/4			178	105	96	70	50	80	120	100	13	46	11	30	12	13.5	4×4×25	28	7	25
60	1/2	1/4		198	120	96	77	60	80	120	100	15	41	11	40	15	17	5×5×35	31	7	25
70	1	1/2		235	140	105	87	70	120	182	150	15	55	15	40	18	20	5×5×35	31	7	28
80	2	1		268	161	120	98	80	130	185	160	16	70	15	50	22	25	7×7×45	42	10	38
100	3	2		322	190	145	117	100	180	235	210	16	85	15	50	25	28	7×7×45	45	12	40
120	5	3		390	231	145	137	120	280	330	300	20	85	17	65	30	33	7×7×60	50	15	45

MODEL: TM-M



★ 50#~120#

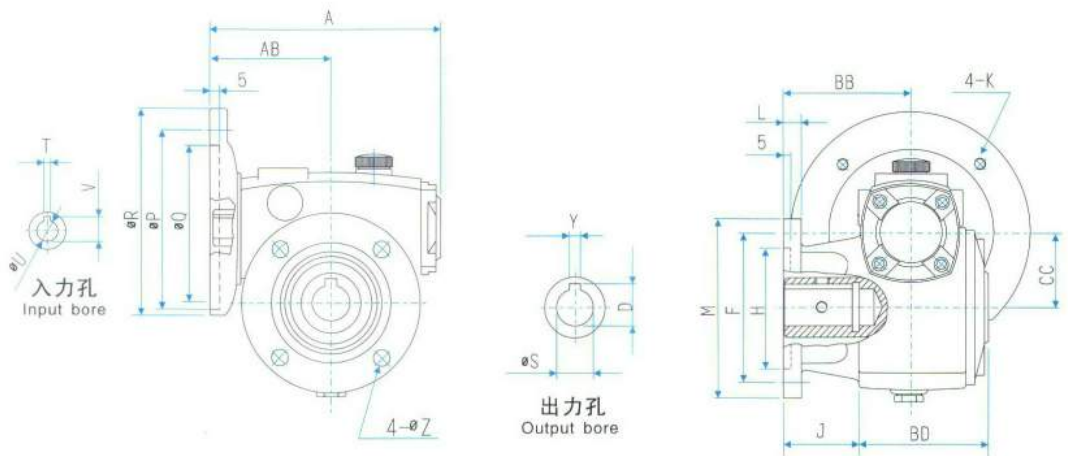

尺寸表 Dimension

單位: m/m

減速比 RATIO	馬力 HP		外形尺寸 OUTWARD SIZE											馬達盤 ICE MOTOR FLANGE				輸入孔 INPUT BORE			出力孔 OUTPUT BORE			
	型號 MODEL	1/10~ 1/30	1/40~ 1/60	A	AB	BB	BD	CC	H	M	F	L	J	Z	P	Q	R	K	V	T	U	D _h	Y	S
50	1/4			154	81	96	70	50	80	120	100	13	46	11	130	110	160	M8	12.7	4	11	28	7	25
60	1/2	1/4		167	86	96	77	60	80	120	100	15	41	11	130	110	160	M8	12.7 16.3	4 5	11 14	31	7	25
70	1	1/2		200	102	103	87	70	120	182	150	15	55	15	130 165	110 130	160 200	M8 M10	16.3 21.8	5 6	14 19	31	7	28
80	2	1		223	116	120	98	80	130	185	160	16	70	15	165	130	200	M10	21.8 27.3	6 8	19 24	42	10	38
100	3	2		278	144	145	117	100	180	235	210	16	85	15	165 215	130 180	200 250	M10 M12	27.3 31.3	8	24 28	45	12	40
120	5	3		323	164	145	137	120	280	330	300	20	85	17	215	180	250	M12	31.3	8	28	50	15	45

以上尺寸如有變動，恕不另行通知

We regret that there will be no separate notification, if the above dimensions have been changed.



FLANGE TYPE WORM GEAR REDUCER HIGH OUTPUT FLANGE 法蘭式蝸輪減速機出大法蘭

MODEL: TM-M60

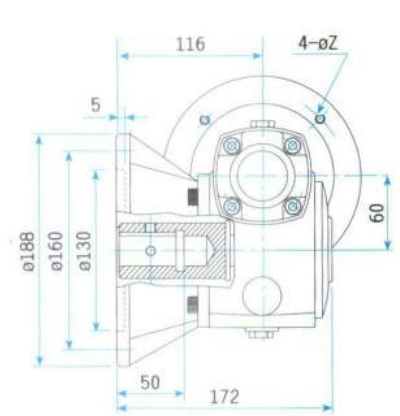
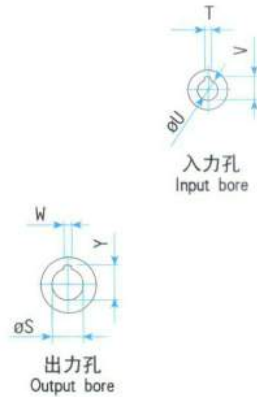
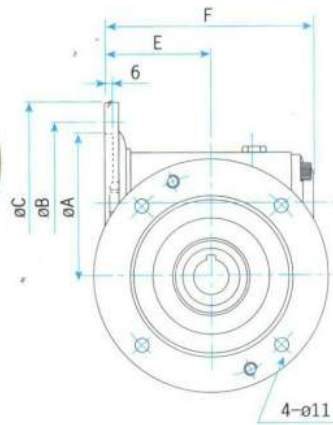

尺寸表 Dimension

單位: m/m

型號 MODEL	馬力 HP (4P)	出力孔 OUTPUT BORE			入力孔 INPUT BORE			入力馬達盤 OUTPUT BORE				E	F
		S	W	Y	U	T	V	A	B	C	Z		
60	1/2	25	7	28.3	14	5	16.3 (18.3)	110	130	162	M8	85	168
		28	7	31.3									
		30	8	33.3									
	1	25	7	28.3	19	6 (5)	21.8 (18.3)	130	165	200	M10	93	176
		28	7	31.3									
		30	8	33.3									

MODEL: TM-MB60

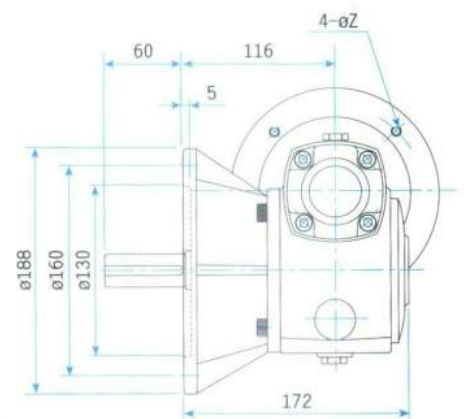
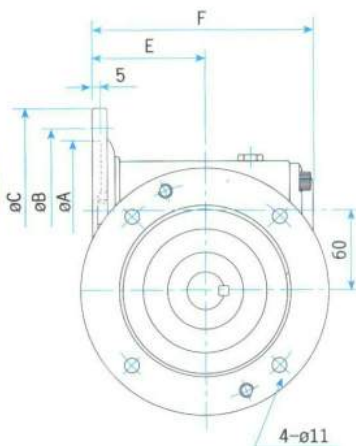

尺寸表 Dimension

單位: m/m

型號 MODEL	馬力 HP (4P)	出力軸 OUTPUT SHAFT			入力孔 INPUT BORE			入力馬達盤 OUTPUT BORE				E	F
		S	W	D	U	T	V	A	B	C	Z		
60	1/2	25	7x7	28	16	5	18.3 16.3	110	130	162	M8	85	168
		28		31									
		30		31									
	1	25	7x7	28	19	6	21.8 18.3	130	165	200	M10	93	176
		28		31									
		30		31									

MODEL:TB-M60

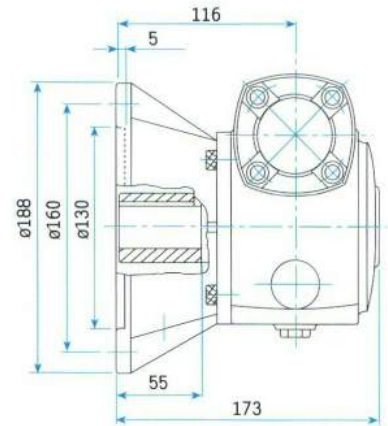
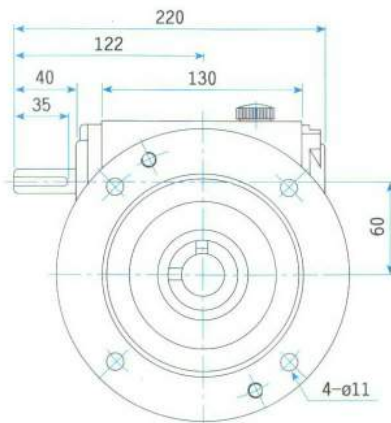

尺寸表 Dimension

單位: m/m

型號 MODEL	馬力 HP (4P)	出力孔 OUTPUT BORE		
		S	W	Y
60	1/2	25	7	28.3
		28	7	31.3
		30	8	33.3

MODEL:TB-MB60

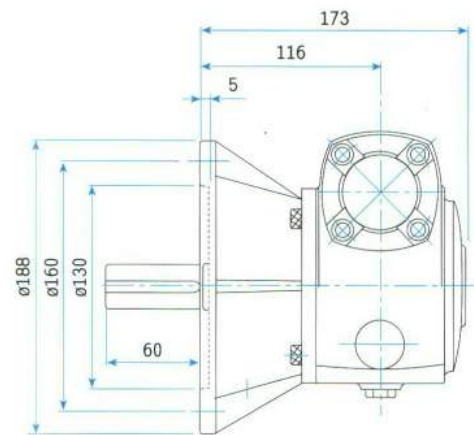
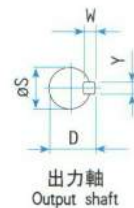
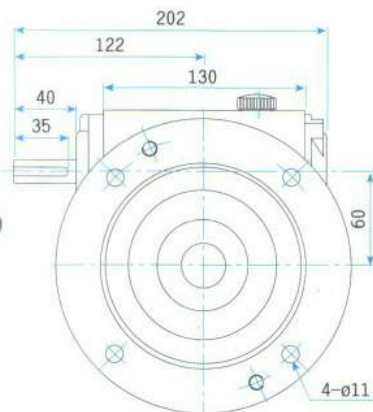

尺寸表 Dimension

單位: m/m

型號 MODEL	馬力 HP (4P)	出力軸 OUTPUT SHAFT		
		S	WxY	D
60	1/2	25	7x7	28
		28		31

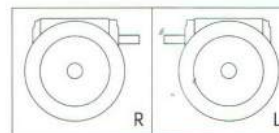

軸向選擇 Shaft Direction

以上尺寸如有變動，恕不另行通知
We regret that there will be no Sepcirate notification, if the above dimensions have been changed.



FLANGE TYPE WORM GEAR REDUCER HIGH OUTPUT FLANGE 法蘭式蝸輪減速機出大法蘭

MODEL:TOM



★70#~100#

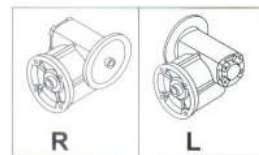

安裝方向選擇
Direction of installation

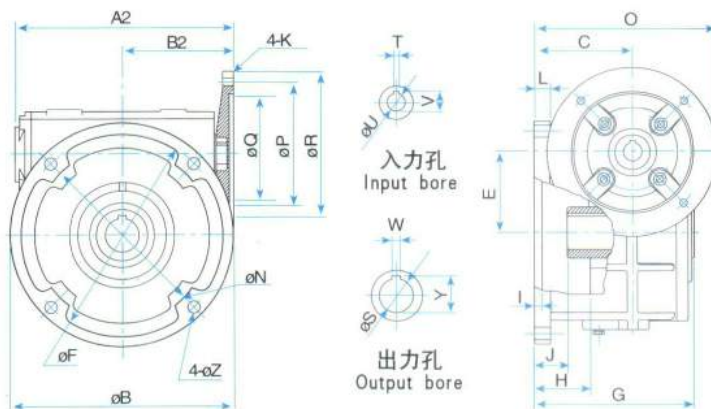

尺寸表 Dimension

單位: m/m

減速比 RATIO	馬力 HP	A2	B2	B	C	N	E	F	G	H	I	J	L	O	Z	馬達盤 MOTOR FLANGE				入力孔 INPUT BORE			出力孔 OUTPUT BORE			
																P	Q	R	K	V	T	U	W	Y	S	
70	1	1/2	200	108	182	106	115	70	150	168	45	8	40	17	186 206	15	130 165	110 130	160 200	M8 M10	16.3 21.8	5 6	14 19	7	28.3	25
80	2	1	223	118	200	107	130	80	170	181	34	8	33	20	207	15	165	130	200	M10	21.8 27.3	6 8	19 24	10	38.3	35
100	3	2	278	114	248	132	180	100	215	205	55	8	46	22	232 257	15	165 215	130 180	200 250	M10 M12	27.3 31.3	8	24 28	10	43.3	40

★120#~135#

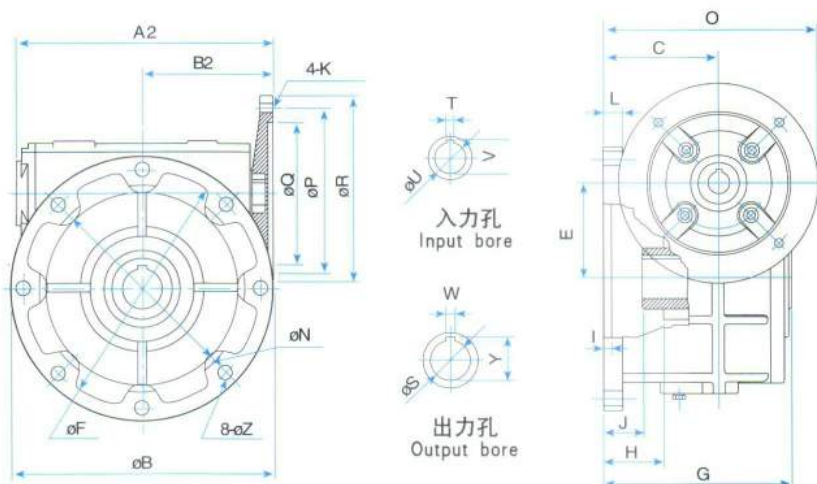

尺寸表 Dimension

單位: m/m

減速比 RATIO	馬力 HP	A2	B2	B	C	N	E	F	G	H	I	J	L	O	Z	馬達盤 MOTOR FLANGE				入力孔 INPUT BORE			出力孔 OUTPUT BORE			
																P	Q	R	K	V	T	U	W	Y	S	
120	5	3	323	164	330	145	260	120	300	229	60	6	56	24	270	18	215	180	250	M12	31.3	8	28	12	53.3	50
135	7 1/2	5	369	187	360	155	290	135	330	244	65	7	63	25	280 305	18	215 265	180 230	250 300	M12	31.3 41.3	8 10	28 38	15	59.3	55



MODEL:TO



★ 70# ~ 100#

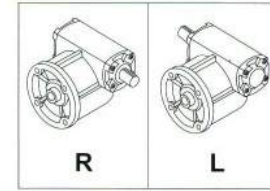

安裝方向選擇 Direction of installation

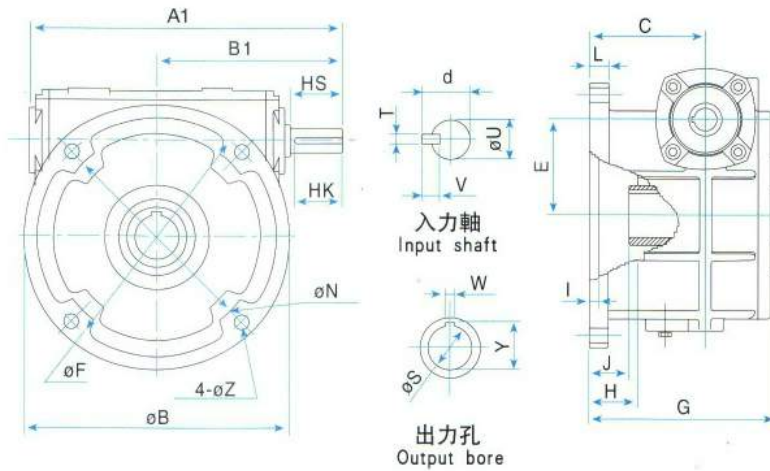

尺寸表 Dimension

單位: m/m

減速比 RATIO	馬力 HP		A1	B1	B	C	N	E	F	G	H	I	J	L	Z	入力軸 INPUT SHAFT				出力孔 OUTPUT BORE		
	型號 MODEL	1/10~ 1/30														1/40~ 1/60	HS	U	d	TxVxHK	W	Y
70	1	1/2	235	140	182	106	115	70	150	168	45	8	40	17	15	40	18	20	5x5x35	7	28.3	25
80	2	1	268	161	200	107	130	80	170	181	34	8	33	20	15	50	22	25	7x7x45	10	38.3	35
100	3	2	322	190	248	132	180	100	215	205	55	8	48	22	15	50	25	28	7x7x45	10	43.3	40

★ 120# ~ 135#

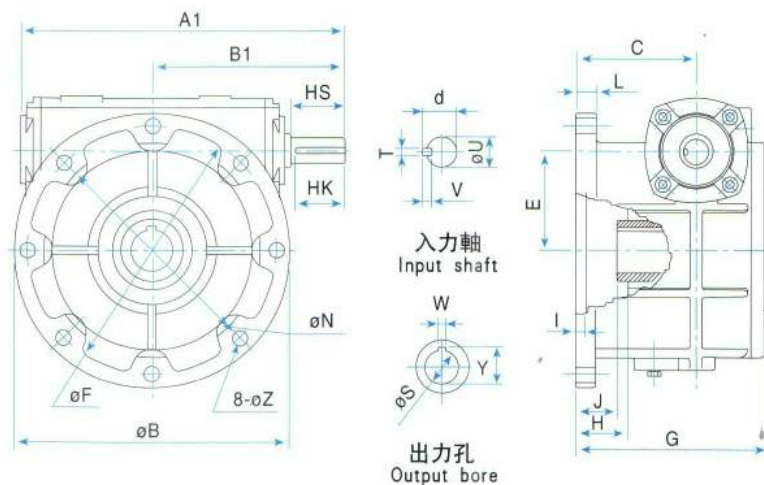

尺寸表 Dimension

單位: m/m

減速比 RATIO	馬力 HP		A1	B1	B	C	N	E	F	G	H	I	J	L	Z	入力軸 INPUT SHAFT				出力孔 OUTPUT BORE		
	型號 MODEL	1/10~ 1/30														1/40~ 1/60	HS	U	d	TxVxHK	W	Y
120	5	3	390	231	330	145	260	120	300	229	60	6	56	24	18	65	30	33	7x7x60	12	53.3	50
135	7 1/2	5	438	258	360	155	290	135	330	244	65	7	63	25	18	75	35	38	10x8x70	15	59.3	55

以上尺寸如有變動，恕不另行通知
We regret that there will be no separate notification, if the above dimensions have been changed.

